

Section 6

Fork Assemblies	11-22
Fork Covers.....	9,13-14,18-19,35-36
Fork Tubes & Springs	23-26,37
Fork Stem Parts.....	29-34
Handlebar Controls / Wiring / Levers	74-80
Handlebar Mount Kits	62-64
Handlebars	56-61
Head Light Cowlings	9-10,18-19
Mirrors	42-55
Neck Cups	26-28,41
Risers	65-73
Springer.....	11
Throttle Grips	81-88
Tins	18-19
Triple Trees	12,29-33
Wideglide Conversions	32
Windshields	2-8

Windshields



National Cycle Windshields are made of GE Lexan Polycarbonate



Ranger Heavy Duty Winshield (N2290)
 Very light tint, 13 1/2-15 1/2" high and 16 1/2" wide
52130 Windshield for all models listed below
82061 Billet trim for above
27165 Chrome bracket mounting kit
27291 Single holdster bag for Ranger shield

XL Models

XLH 1957-98
 XL 1200C, XL 1200 S, XL 883C 1996-00
 XLH Custom 1996-00
 XLH 1100 1986-88
 XLH 883, XLH 1200 1987-00

FX Models (Narrow Glides)

FX, FXE, FXEF 1970-85
 FXS, FXSB 1977-85
 FXLR 1987-94
 FXR, FXRS 1982-94
 FXDS 1994-99
 FXD, FXDL, FXDX 1993-00
 FXDG 1983

27166 Bracket kit to mount N2220 and 2290 to Wide Glides
27071 Black, as above



H: 13 1/2" to 15 1/2"
 (34.3 cm-39.4 cm)
 W: 16 1/2" (42 cm)

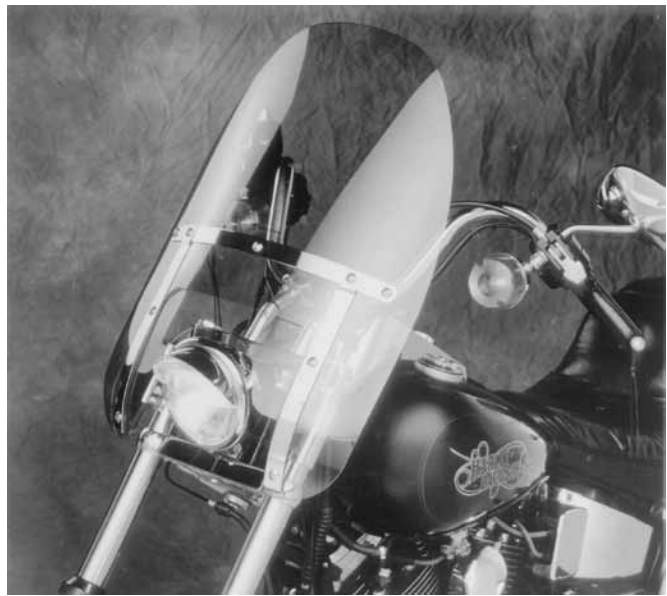

Custom Heavy Duty Windshield (N2220)
 Same look as the Ranger but larger, 19-21" high and 18 3/4" wide

52129 Windshield for all models listed below
82060 Billet trim for above
27165 Chrome bracket mounting kit
27291 Single holdster bag for Custom Heavy Duty shields

XL Models

XLH 1957-98
 XL 1200C, XL 1200 S, XL 883C 1996-00
 XLH Custom 1996-00
 XLH 1100 1986-88
 XLH 883, XLH 1200 1987-00

FX Models (Narrow Glides)

FX, FXE, FXEF 1970-85
 FXS, FXSB 1977-85
 FXLR 1987-94
 FXR, FXRS 1982-94
 FXDS 1994-99
 FXD, FXDL, FXDX 1993-00
 FXDG 1983



H: 19" to 21" (48.5 cm
 -53.3 cm)
 W: 18 3/4" (47.5 cm)



Mounting kit #27165



Ranger with optional billet trim #82061



Custom Heavy Duty with optional billet trim #82060



Flyscreen LS

Small windshield with a very custom appearance. Triple chrome front plate. Flush counter sunk hex bolts. Measures 8-1/2" high, 9-3/4" wide and includes mounting brackets. These shields fit all models listed below. Dark tint DOT and TUV approved for night use.

52133 Dark tint (N2531)

XL Models

XLH 1957-98
 XL 1200C, XL 1200 S, XL 883C 1996-00
 XLH Custom 1996-00
 XLH 1100 1986-88
 XLH 883, XLH 1200 1994-00
 XLH 883, XLH 1200 1987-93

FX Models (Narrow Glides)

FX, FXE, FXEF 1970-85
 FXS, FXSB 1977-85
 FXLR 1987-94
 FXR, FXRS 1982-94
 FXDS 1994-00
 FXD, FXDL, FXDX 1993-00
 FXDG 1983

FX Wideglides

FXST 1984-90, 1999-00
 FXSTC 1987-00
 FXWG 1980-85
 FXDWG 1993-00



Street Shield

The shield of choice when your height or riding position requires a bit more windshield than the Deflector Screen offers. Four point mounting with adjustable mounts. Measures 17" high, 16-1/2" wide and is DOT and TUV approved. Hardware included.

52137 Street Shield EX with light tint (18"H x 19-1/4"W)

XL Models

XLH 1957-98
 XL 1200C, XL 1200 S, XL 883C 1996-00
 XLH Custom 1996-00
 XLH 1100 1986-88
 XLH 883, XLH 1200 1994-00
 XLH 883, XLH 1200 1987-93

FX Models (Narrow Glides)

FX, FXE, FXEF 1970-85
 FXS, FXSB 1977-85
 FXLR 1987-94
 FXR, FXRS 1982-94
 FXDS 1994-00
 FXD, FXDL, FXDX 1993-00
 FXDG 1983

FX Wideglides

FXST 1984-90, 1999-00
 FXSTC 1987-00
 FXWG 1980-85
 FXDWG 1993-00



H: 8 1/2" (21.5 cm)
 W: 9 3/4" (25 cm)



H: 17" (43 cm)
 W: 16 1/2" (41.9 cm)

Windshields

National Cycle Windshields are made of GE Lexan Polycarbonate



Touring Heavy Duty For Wide Glides

Full height wide screen with a very light tint,
21 1/2" wide

- 52125** Windshield for all models listed below
- 27168** Chrome mounting kit
- FXDG 1983
- FXST 1984-90, 1999-00
- FXSTC 1987-00
- FXWG 1980-85
- FXDWG 1993-00



27168

- 52125** Windshield for all models listed below
- 27167** Chrome mounting kit
- FLST 1986-90
- FLSTC 1987-00
- FLSTF 1990-00

- 52118** Windshield for all models listed below
- 27169** Chrome mounting kit
- FL Duo 1960-84

- 52118** Windshield for all models listed below
- *Requires OEM windshield frame brackets*
- FLHS 1977-83



With billet trim #82059 for Chopped and Touring Shields



Chopped Heavy Duty For Wide Glides

Wide screen look with a low profile. Very light tint, 15-18" high and 21 1/2" wide

- 52126** Windshield for all models listed below
- 27168** Chrome mounting kit
- FXDG 1983
- FXST 1984-90, 1999-00
- FXSTC 1987-00
- FXWG 1980-85
- FXDWG 1993-00



27168

- 52126** Windshield for all models listed below
- 27167** Chrome mounting kit
- FLST 1986-90
- FLSTC 1987-00
- FLSTF 1990-00

- 52127** Windshield for all models listed below
- 27169** Chrome mounting kit
- FL Duo Glide 1960-84

- 52128** Windshield for all models listed below
- *Requires OEM windshield frame brackets*
- FLHS 1977-93



82062 Triple Holdster bag for Chopped and Touring shields

Windshields

Beaded Heavy Duty for Wide Glide Forks
 Classic look of the 50's models, colour lowers and windshields available, 19"-22" high, 21½" wide



For FLST Models Listed

- 52120** Clear lower
- 52122** Blue lower
- 52123** Black lower
- 27167** Chrome mounting bracket kit
- 27072** Black, as above
- 82062** Triple holdster bag



For FXST Models Listed

- 52120** Clear lower
- 52122** Blue lower
- 52123** Black lower
- 27168** Chrome mounting bracket kit
- 27073** Black, as above
- 82062** Triple holdster bag



27168

- FLST 1986-90
- FLSTC 1987-00
- FLSTF 1990-00
- FLSTN 1993-00

27167

- FXST 1984-90, 1999-00
- FXSTC 1987-00
- FXWG 1980-85
- FXDWG 1993-00

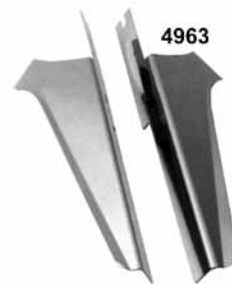

Chrome Wind Deflectors

- 2416** Fits FLH front ends 1960-84
- 4051** Fits FLHT 1983-85
- 4963** Fits FLHT, FLHR 1986-on without fairing lowers

FLHS Models 1977-93

- 52134** Clear lower
- 27169*** Chrome mounting bracket kit
- 82062** Triple holdster bag



27169

Note: FLHS Requires OEM windshield brackets or equivalent and FLHS window



Replacement Windshields for all years of FLH

PCP	Height	Colour
52003	18"	Clear
52004	18"	Tint



"Chopped" Replacement Windshields for FLH

PCP	Height	Colour
52006	7"	Tint



T/L Chrome Softail Wind Deflectors 1986-on

Fully customize the look of your Heritage Classic model Softail with these chrome wind deflectors which have been designed to work with 5 gallon Fat Bob tanks. Fits 1986-on FLST, FLSTC, FLSTF, 1993-96 FLSTN models equipped with a kingsize windshield and or a passing lamp kit. Does not fit FLSTS. When deflectors are installed windshield cannot be adjusted without additional purchase of OEM# 58155-90. **29217 58125-90B**



Chrome Finned Bullet Krommet

469 10 Packs



Chrome Windshield Krommets

Fit in place of stock nuts & bolts.
466 Set of 11



Chrome Star Washers

Ideal for use in mounting trims or accessories to fiberglass or plastic.
411 Sold in 10 packs



Chrome Bullet Krommets

465 10 Packs

Conversion & Replacement Windows



A

ROUND (FLST, FX type)

Clear	52020
Red	52021
Blue	52022



B

FLH NOTCHED

Clear	52010
Blue	52012



C

FLHS WINDOW

Clear	52030
Red	52031
Blue	52032
Black	52033



D

Window for 52130 and 52129 Shields
Clear 52034

Beaded Heavy Duty

Clear	52120
Blue	52122
Black	52123

FLH Replacement

18" Clear	52003
18" Tint	52004
7" Tint	52006

FLHT Replacement

12" Clear	52007
6" Tint	52008



Windshields



29408

Windshield Pouch

Road King style for mounting on king sized shield cross bar (except Nostalgic, Flame and Skull with wings).

29408 With logo (58297-94)



T/L Windshield Bag with Concho 1984-on

These Fat Boy style bags feature a leather laced lid with die-cast concho. Fits all 1984-on Softail models using H-D king size and compact windshields that do not have handlebar rise mounted gauges. These bags do not work with 100th anniversary logo windshields.

29440 56626-99



27088



27086



27087

FLH Windshield Bracket Kit

PCP Application

27086 1986-93 FLST (57951-92T)
1987-93 FLSTF
1988-92 FXSTS

27087 1987-92 FLHS (57953-92T)

27088 1993 FLHS



FLT Chrome Lower Fairing Trim

Is perfectly formed to cover the cracked or peeling decals. Installs easily.

PCP Type

45021 1986-95 (14098-91)

45034 1996-on



52036



52036

Chopped Fairing Screen

Fits FLHT with fairing 1986-95.

PCP Type

52035 Clear 12"

52036 Tint 6"



FLHT Chrome Windshield Trim 1986-on

Fits BT shields on fairing models. Utilizes stock mounting hardware. Foam backed to prevent scratching shield.

52013

Windshields

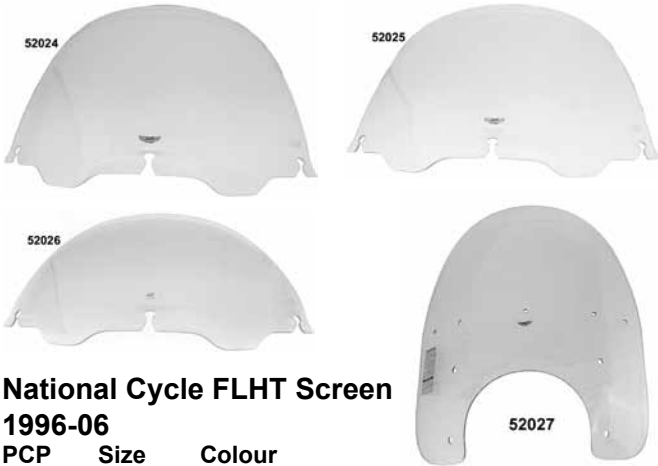

National Cycle FLHT Screen

1996-06

PCP	Size	Colour
52024	12-3/4"	Clear
52025	12-3/4"	Light tint
52026	8-3/4"	Dark tint
52027	Stock	Clear 1994-07

FLHR only



Flyscreens (Bronze) for 7" Headlight

PCP	Fits
52131	7" Headlights
52106	5.5" Headlights



FLT Fairing Bracket Set 1998-03.
21865

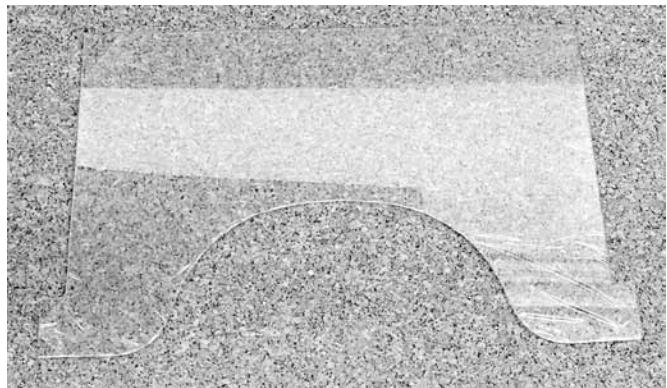

Ranger Clear Window
52000



Windshield Grommet

Fits stock windshield on FLT 1987-95 and 1996 FLTCUI.
23078 11453 (pair)

Light Housings

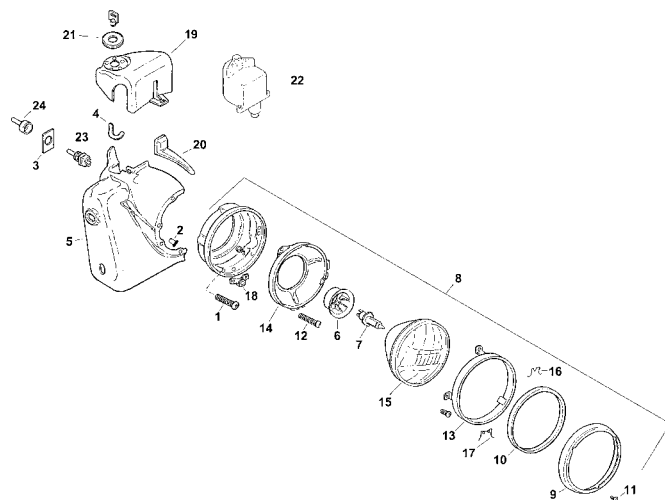

Chr. Headlight Complete Housing Assembly

Fits FLT 1986-on to update to the Road King style. Includes right and left side and headlamp assembly with rim.

PCP Description

- 90419** Complete housing assembly with lamp (shown)
- 90409** Housing set only (67682-03A, 67674-03A)
- 66140** Handlebar top cover (67866-94)
- 62801** Headlight assembly 1981-02 (67702-81A)
- 66141** Lower chrome fork cover set (45963-97)
- 66142** Spot lamp bracket (68712-94A)
- 66143** Top trim strip 1994-02 (67868-94)
- 66144** Rear trim strip (11489)
- 44402** Adapter kit to attach chrome visor (67761-96)

FLHR Chrome Headlamp and Nacelle 1999-on

- | # | PCP | Description |
|----|--------------|---|
| 1 | 24515 | Screw, headlamp pot (922) (10 pk) |
| 2 | 23032 | Wellnut (5210) (10 pk) |
| 3 | 78100 | On-Off label (14019-83) (each) |
| 4 | 66144 | Rubber trim (11489) (2 pc) |
| 5 | 29806 | Nacelle, right 1994-02 (67674-94) |
| | 90409 | Nacelle set 1999-on (67674-03A, 67682-03A) |
| 6 | 23084 | Boot, bulb 1981-04 (67696-81) |
| 7 | 17004 | H-4 Halogen bulb 1994-02 (67697-81) |
| 8 | 62801 | Complete h/light assembly 1981-02 (67702-81A) |
| 9 | 28426 | Door, chrome (67712-83) |
| 10 | 23013 | Gasket, headlamp door (67716-60A) (ea) |
| 11 | 24521 | Screw, headlamp door (67718-60A) (10 pk) |
| 12 | 24562 | Head lamp adjusting screw (67724-71) (5 pk) |
| 13 | 28431 | Retaining ring, seal beam (67001-08) |
| 14 | 28432 | Mounting ring (67732-71) |
| 15 | 56127 | Lense housing 1981-02 (67755-81A) |
| 16 | 13004 | Top retaining spring 1981-02 (67778-60) (10 pk) |
| 17 | 13005 | Bottom retaining spring 1981-02 (67780-60) (10) |
| 18 | 78101 | Retainer screw bracket 1960-04 (67782-60A) |
| 19 | 66140 | Handlebar cover 1994-02 (67866-94) |
| 20 | 66143 | Trim, nacelle top 1994-02 (67868-94) |
| 21 | 78102 | Trim, fork lock (71310-94) |
| 22 | 29505 | Fork lock 1994-02 (71540-94) |
| 23 | 78103 | Switch, spotlight and accessory (71522-96) |
| 24 | 78104 | Boot (74408-89) (ea) |



Chrome Steel Upper Fork Covers

These unique fork covers allow easy installation over stock covers without disassembly or removal.

- 45193** 1994-on FLHR/C (68062-94)
- 45194** 1986-96 FLTC/U/I, 1987-93 FLHS, 1998-on FLTR (68064-94A)
- 45195** 1986-on FLHT/C/U (68063-94)

Chrome Fork Cover Side Trim Strips

Trim strips replace OEM style alloy strips on FLST 1986-on and FLSTN 1993-96. Will not work with spot-lamps or windshields.

- 45324** 67891-99

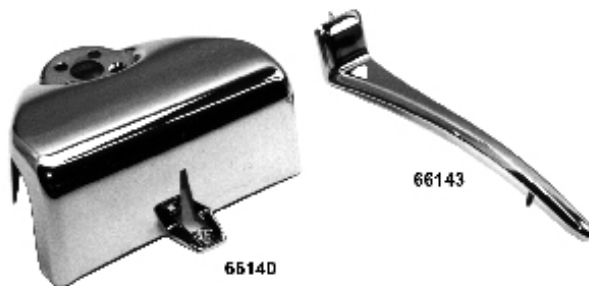

Chrome FLHR Nacelle Trim

Chromed replacement pieces to fit 1994-02 Road Kings.

- 66140** Riser cover (67866-94)
- 66143** Spear trim (67868-94)

Light Housings



90416

Chrome 7" Headlight Cowl Kit

Kit includes chrome ABS headlight housing, 7" H-4 lamp assembly with rim, upper fork covers and chrome fork air baffle. Fork covers can be installed without disassembly of forks. Fits 1980-86 FLT and 1983-85 FLHT-FLHTC.

PCP Application

90416 1980-86 FLT, 1983-85 FLHT
90417 1987-92 FLHS



90407

FLST Headlight Cowlings

These chrome cowlings feature the early 1960's styling for FL front ends but designed to fit 1986-on FLST and 1990-on FLSTF models. They are die-cast. They require the FLST style head light internals listed below or OEM parts.

90407 Cowling set
90408 Cowling set with lamp and riser cover
45094 Handlebar cover for #90407 (chromed)
62801 Lamp assembly with halogen light
62802 Lamp assembly with standard seal beam



56345

Headlight Housing, Light not included

PCP Description

56344 Chromed ABS FLHS 1987-92, FLHT 1983-85 (67680-91)
56349 As above with hole (67680-91)



90419



45111

Custom Lower Triple Tree Covers

Chrome steel covers mount under the lower triple tree to hide the rough stock casting.

45111 Road King 1994-99

Chrome Head Lamp Housing Kit

Use this kit to update to a Road King style on 1986-on FLT models. Kit for left and right sides includes housing assembly, handlebar top cover, headlamp assembly, top and rear trim strip and mounting hardware. Complete assembly also includes chrome upper fork leg covers and fork air baffle.

PCP Description

90419 Housing kit
90422 Complete assembly



90422



T/L Wheel and Brake Kit 2000-04

Kit includes wheel, four piston brake caliper assembly, brake rotor, front axle and necessary mounting hardware. Fits 2000-on FXST, FXSTB and FXDWG models. Does not fit FXSTS or FXSTD. Also requires the separate purchase of front end kit 45332-00 or 45371-00.

90502 44389-00



Wide Spring Fork Assembly

Features fully chromed front and rear leg with 1" stem, springs, top tree and fender mounting tab. Works with single disc brake 1984-99 style with 21" wheel. Measurement is from top of tree to axle centre.

PCP	Length
98094	30"
98096	34"
43257	Axle kit
88209	Fender
70856	21" Wheel



FLT Forks



FLT Triple Trees 1979-on

These USA made trees are available in the stock finish. Lower trees are black and top trees are a zinc colour. Great for installing custom combinations or for stock repair projects as these parts interchange exactly.

PCP Description

- 69513** Zinc upper tree 1979-92 (45435-83B)
- 69514** Black bottom tree 1987-08 (45446-87A)
- 69516** Black upper tree 1995-08 (45435-95)



FLT Fork Assembly 1984-99

Includes lower sliders with all internals and stock length tubes installed, black triple tree set, chrome slider covers, axle nuts, bearings and dust covers. Accepts FLHR cowl set and 11" dual disc components (not included).

PCP Description

- 98098** Complete fork assembly w/chrome sliders
- 70796** 16" Chrome wheel
- 90409** Cowl housings only
- 90419** Cowl assembly w/head light
- 90422** Cowl complete assembly w/fork leg covers
- 66140** Top handlebar clamp
- 66143** Cowl top trim piece
- 98101** Chrome Right and left leg assembly
- 69516** Black upper triple tree
- 69514** Black lower triple tree
- 51400** Chrome upper tree
- 51401** Chrome lower tree
- 51402** Chrome tree set
- 45702** Chrome slider covers
- 43131** Axle and fork bearing kit



Fork Installation Kits

Kits include 2 bearings, dust covers, top nut axle and hardware.

PCP Application

- 43128** Single FXST 1984-99
- 43129** Single FLST 1986-99
- 43130** Single stock FLST 1986-on
- 43131** Dual stock FLT, FLHT 1984-on



Chrome Front Fork Air Baffle

Fits 1980-on FLT, FLHT, FLHR, FLHX models. Does not fit FLTR 1998-on.

- 45447** 58520-79B



Chrome Lower Rear Fork Stem Cover

- 64269** Touring models 1987-on (66058-01)

Front End



FLT Chrome Fork Assembly 1980-on

Features chrome triple trees, chrome or polished lower legs, axle, chrome upper fork covers and full chrome cowl and handlebar top cover assembly. Units accept dual disc caliper as required by year. 1980-86 models require 1987-99 front caliper set.

1980-99

PCP	Lower Legs	Trees
98207	Polish	Chrome
98208	Chrome	Chrome

2000-on

98209	Polish	Chrome
98210	Chrome	Chrome



Chrome Lock Cover FLHR 1994-02

Cover pivots to allow access to fork lock.
44007



"Gator" Fork Boots

Black, flexible rubber boots measure 230mm long and fit FXST-FXDWG-FXWG 41mm forks or FXD-XL 39mm forks.

PCP	Size
23079	41mm
23080	39mm



23079

FLT Fork Stop Rubber 1979-on

Fits 1979-on FLT models and replaces 47530-79B.

73550



FLT Neck Bearing and Hardware Set

59934 1980-on FLT

Front End



FXSTD Style Chrome Leg Assemblies 2000-05

Assemblies include FXSTD style lower legs with all internals installed.

PCP Length
98110 31.5" (standard) (46064-00, 46066-00)

Parts for FXSTD Forks 2000-05

PCP Application
51458 Top and lower tree set (45769-00, 45475-00)
43248 Axle with acorn nuts (43354-00)
88228 Raw fender like stock (59876-00)
88231 Raw fender w/chrome bracket (59876-00)
73551 Headlight mount block (69163-00)
73552 Axle spacer right (43623-00)
12647 Cover cone nut (48324-00)
12625 Top hex nut kit (45718-60)



Chrome Head lamp Filler Cover

Polished and chrome plated steel cover completely fills in the area between the head lamp and the fork tubes. Fits 2000-07 FXSTD models and is stock on 2003-04 FXSTDSE. Includes mounting hardware. Does not work with windshield.

64264 69335-03

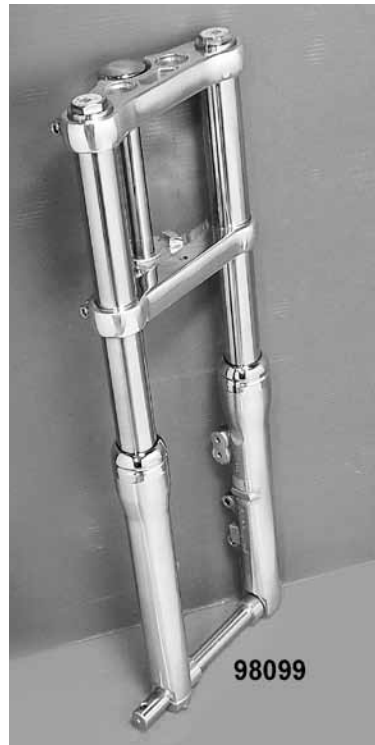

Complete 49mm Fork Assemblies

Includes tree set, right and left slider, polished legs and axle to fit 1991-on FXD, FXDWG.

PCP Application
98099 FXD
98100 FXDWG



Fork Stop Kit

Use to adapt billet trees to FXD & BT models.

40055 FXD
40053 BT



Chrome Riser Adaptor Kit

Allows the use of custom risers on the FXSTD Deuce.
51021

Fork Assemblies



Chrome FL Softail Front End Kit

Complete front end kit features 2000-06 model internal valving components, assembled chrome fork sliders, chrome upper fork covers, upper chrome triple tree, lower triple tree, bearings and hardware.

PCP Application

98066 FLSTF, FLSTC 2000-06 (46918-00)



84-99 FXST Style Single Disc Fork Assembly

Includes chrome triple trees, axle bearings and related hardware. Lower legs are polished aluminum, tubes hard chrome finish, 31" overall length. Order caliper separately to accept an 11" stock rotor.

98030 1984-90 complete, polished sliders

98032 As above complete, chrome sliders

98031 1991-99 complete, polished sliders

61012 Caliper, left, black, (44046-84B)

46758 Caliper, left, chrome (44046-84C)

Note: Assemblies come with fork oil in tubes but assembler is advised to drain and refill oil.



Chrome FX Softail Front End Kit

Complete front end kit includes assembled chrome fork sliders, chrome billet fork dust shields, chrome upper fork nut caps, chrome triple tree set, chrome acorn nuts and chrome drain screws. The kit also includes improved fork damping springs and valves, triple tree roller bearings, braces and dust shields.

PCP Application

98068 FXST/B 2000-on (46224-00)

98069 FXST/B/C 1991-99 (45765-00)



Fork Tube Components

Assemblies include chrome fork tube plug and caps, seals, springs, and damper kit.

82094 1984-99 FXST

Fork Assemblies



90902

FXST Style Single Disc Front Fork Assembly

These kits are offered with polished lower legs (without reflector boss), to accept a left side single disc caliper for a 1984-99 style front end. Also includes a drilled 11" rotor with chrome screws. The hard chromed fork tubes are assembled with oil (but recommend oil level be checked). The 21" wheel assembly is all chromed and trued. Calipers are complete with pads. Kit as shown. Stock length is 31" overall.

PCP 1984-99

90902 Kit with black caliper



90901

FXWG Dual Disc Fork, 21" Wheel/Caliper Kits

Assemblies are available with chrome or polished lower sliders with hard chrome fork tubes and internals installed without reflector boss to accept dual disc calipers, 10" rotors, chrome trees with lock tab, neck bearings, axle spacer, and top nut. Stock length is 31" overall. Kit also includes a 21" all chrome, assembled wheel with bearings, drilled 10" rotors with chrome screws; and choice of black or chrome dual disc calipers complete with pads.

PCP Application

90900 BT with black calipers

90901 BT with chrome calipers

90908 BT with chrome lower sliders and calipers



Chrome Upper Fork Nut Covers

Chrome plated nut covers feature grooved design and logo insert to finish the appearance of the upper fork area.

29207 1986-on FLSTC, 1990-on FLSTF, 1995-05 FXD, 1993-on FXDL, 1994-05 FXDS, FLSTN 2005-06, FXST 2006-07, FLSTF 2007 and 1988-on XL 883 (not 1200S or 883/1200 custom) (46129-98B) (3 pk)

29208 2000-05 FXST/B/D, 1986-99 FXSTC, 1993-05 FXDWG (45002-98)



Allen

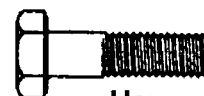

Hex

Lower Stem Pinch Bolts

Offered in chrome allen or zinc finish hex caps. Chrome allen set for FXWG-FXST includes head light bracket screws, XL set includes screws for side of tree.

PCP Type Fits

24017 Hex 1973-86 FX-XL, zinc (4411)

24018 Hex 1949-on FL-FXWG-FXST, zinc (4729)

9803 Hex As above in chrome (4729)

24019 Allen 1973-86 FX-XL, chrome

9782 Allen 1949-on FL-FXWG-FXST, chrome



Chrome Billet 41mm Fork Assemblies 49-99

Fork assembly fits 1949-99 FX-FL-FXST and includes chrome billet trees and chrome billet lower legs. Kit also includes chrome fork tubes assembled into legs with chrome boot dust covers. Forks accept single disc caliper and 11" rotor.

PCP	Length
98073	Stock (31")
98075	+4"
98076	+6"
98078	+10"



Chrome Billet 41mm Fork Assemblies

For 1949-99 FX-FL-FXST includes chrome billet trees, chrome ball milled billet lower legs, flush mount axle and chrome fork tubes assembled into legs with chrome boot dust covers. Forks accept single disc caliper and 11" rotor.

PCP	Length
98232	Stock (31")
98234	+4"
98235	+6"



Fork Installation Kits

Kits include 2 bearings, dust covers, top nut axle and hardware.

PCP	Application
43128	Single FXST 1984-on
43129	Single FLST 1986-on
43130	Single stock FLST 1986-99
43131	Dual stock FLT, FLHT 1984-on



Billet Chrome Phatt Fork Assembly FXST Stock Rake

Features smooth top tree, massive fork tube covers, hidden fork stops, smooth billet lower legs and hidden axle. Trees are stock FXST rake. Available in stock 31" to +6" extended lengths. Uses 11-1/2" single disc and caliper assembly. Order tree set and leg set separate as two numbers. Tree set includes upper covers and leg set includes lower covers in the correct length for tube application. Note: Parts listed here are not compatible with any other trees or legs in this catalogue.

PCP	Item
51459	Trees only, stock rake
51415	Trees only, 3 degree rake
51416	Trees only, 5 degree rake

Leg Assemblies

For Stock Rake Trees		For Raked Trees	
PCP	Length	PCP	Length
98042	+4"	98043	31
		98045	+4"
		98046	+6"

Fork Assemblies



45701

Chrome Fork Cover Kits FLST/C/F

Fit FLST 1986-on in 3 piece tin set or 5 piece which includes slider covers, stock length. Also fits 1993-96 FLSTN.

Chrome Fork Cover Kits

45700 3 Pc set

45701 5 Pc set

Slider Covers

Chrome	Stainless	Item
45702 Stock	69552 Stock	Slider covers
45703 2" over	45707 2" over	Pair

Accessories

27535 Rear panel mount brackets (pair)

12633 Clip nut panel mount (10 pk)

27536 Complete fork cover mount kit

9981 Chrome screw kit



45706

FLST Complete Chrome Cover Kit

Fits FLST/C/F 1986-on and FLSTN 1993-96. Includes front panel left and right panel, upper slider covers, side trim strips and mount hardware. For FLST/C/F 1986-on and FLSTN 1993-96.

45706

FLST Type Fork Assembly 1986-99

Featuring polished or chrome lower sliders, FLST style, that accept 11" single disc components. This assembly includes chrome trees, slider covers, bearings, dust covers, axle and nut. Fits FL's 1949-84, FXE 1971-84, and FXST models 1985-99. A Single black or chrome caliper is available separately.

98037 With FLST style chrome trees and polished lower legs. Will accept Heritage/Fatboy style tins.

98038 As above, with chrome lower legs.

61012 Black caliper, (left)

46758 Chrome Caliper, (left)

Installation kit also available separately

17259 Kit



Fork Panel Mounting Kit

Fits FLSTC, FLSTF, FLSTN 1987-on.

9981

Fork Assemblies



FLST Chrome Cowl Assembly 1986-06

1960's FL style nacelle includes hardware for installation with detachable windshield and no passing lamp. Hardware kit #16315, sold separately, is required when installing nacelle with rigid mount windshield and passing lamps. Fits 1986-06 FL Softail models (except FLSTN, FLSTS, FLSTSC). 2007 FLSTF models require separate purchase of OEM# 56789-05 riser adaptor kit. Does not fit with adjustable height windshields OEMs 57703-02 or 57704-02

- 90407** Cowl assembly (67907-96)
- 16315** Hardware (67897-96)



FLST Style Complete Front End Assembly

Includes the complete fork kit, 5 piece chrome fork cover set, 7" headlamp and bracket, 16" chrome wheel, speedometer drive, chrome or black caliper, 11" drilled disc, and a FLST style fender.

FLST Style 1986-99

- 90906** Assembly with black caliper
- 90907** Assembly with chrome lower sliders and caliper



49mm Fork Components for FXWG 2006-on

- | PCP | Item |
|--------------|--|
| 69761 | RH Slide assembly (47288-06) |
| 69762 | LH Slide assembly (47287-06) |
| 69528 | Triple tree set, 2006-07 (polished) (46317-07) |
| 12651 | Top cone nut (48307-06) |
| 63054 | Lower dirt guard (48198-06) |
| 66012 | Axle (40923-06) |



T/L FLST Smooth Chrome Fork Cover Kit

Three piece kit includes front panel and matching left and right panels. Fits all 2000-on FLST/C/F models. Does not fit with extra lighting kit OEM# 69287-05.

- 62803** 66440-05



FLSTS, FXSTS Complete Rocker Rebuild Kits

Includes chrome plated components needed to mount rockers on FLSTS and FXSTS models.

- 72213** 1997-on FLSTS
- 72214** 1988-on FXSTS



18641



18642

Lower Leg Caliper Bushings 1984-on

Bushings fit in lower leg where caliper attaches.

PCP Application

- 18641** 1984-on FXST (each) (46020-84)
- 18642** 1986-on FLST (each) (45934-86)

Fork Leg Assemblies

98110



98101



41 mm Fork Tube and Slider Assemblies

Completely assembled right and left pairs. Units have hard chrome fork tubes and chrome lower sliders, with springs and all internal components installed.

PCP	Disc	Application	Slider
98101	Dual	1984-99 FLT	Chrome
98109	Single	2000-06 FLST	Chrome 46211-01, 46212-01
98110	Single	2000-06 FXSTD	Chrome 46064-00, 46066-00

69757

69759



T/L Chrome Fork Slider Assembly (sold each)

Each kit includes a fork assembly with chrome lower fork slider installed, chrome drain screws, chrome axle cap, and chrome acorn nuts.

FL Softail

- 69757 L/S FLSTC, FLSTF 2000-06 (46211-01)
- 69758 R/SFLSTC, FLSTF 2000-06 (46212-01)
- 69759 L/S FLST/C, FLSTF, FLSTN 1986-99 (46914-00)
- 69760 R/S FLST/C, FLSTF, FLSTN 1986-99 (46915-00)



FXST Chrome Billet Lower Legs 1984-99

Fits 1984-99 FXST models with single disc and 11" rotors.
51449



Lower Fork Stem Retaining Ring

For 1986-on all models. Replaces 45611-86.
11092

Fork Leg Assemblies



Fork Tube and Slider Assemblies

Topline quality polished fork tubes and sliders are sold completely assembled for left and right sides. Includes hard chrome fork tubes, polished lower sliders, springs and all internal components installed.

PCP	MM	Disc	Application
69747	39	Single	FXR 1987-94 (45919-87, 45920-87)
69740	41	Single	FLST/F 1986-93 (45915-86, 45916-86)
69738	41	Single	FXST 1984-90 (46004-84, 46006-84)



Sliders for 1984-99 Big Twin

These high strength forged aluminum sliders include brake bushing and slider cap. Offered in either a polished or high luster chrome finish designed to accept left side 1984-on single disc caliper and internal components.

For FXST models 1984-99 (1984-90 Style)

Replaces 45873-84 & 45874-84

- 51430 Polished sliders
- 51431 Chrome sliders



Revolution Chrome Lower Fork Sets

These sets replace stock polished sliders on stock fork assemblies.

PCP	Application (41mm)
51440	FXDWG, FXST/C/B 1991-99 (45305-98)
51497	FXSTC 2007-on (48660-07)
51441	FLST/C/F/N 1986-99 (45310-98)
51446	FLSTC/F/N 2000-06 (46482-00)
51494	FLSTC/N 2007-on, FLSTF 2008 (46482-07A)
51495	FLSTF 2007 (48661-07)
51442	Touring 1984-99 (45315-98)
51447	Touring 2000-08 (46472-00)
51445	FXDWG 2000-05, 2000-07 FXST/B (46477-07)
51492	FXDWG 2006-08 (46589-06)

39mm Chrome Lower Fork Sliders for Narrow Glides

- 51443 Sportsters (not sport models) and FXD Super Glide 1988-99, FXLR 1987-on and FXR, FXRS 1988-99 (45275-98)
- 51490 FXDL, FXDX, FXDS-Conv 1992-99, 1988-92 FXRT, 1987-94 FXRS-SP (45270-98)
- 51444 XL 2000-07 (except XL 883R & 1200 S/R), FXD 2000-03, FXDL 2001-03 with reflectors (46492-00)
- 51448 FXD, FXDC, FXDL 2004-05 (not FXDWG), XL 2008-on (not XL 883R, 1200N/R) (46562-04A)
- 51493 49mm FXD 2006-on (not FXDWG, FXDF/SE/2) (46586-06)
- 51485 XL 1200R 2004-on, XL 883R 2002-on, 2000 FXDL, 2000 FXDS-Conv (46487-00)



Fork Slider Drain Screws

Buttonhead Allen Screws & Copper Washers

- 9910 (C) Chrome XL, FXR 1973-on, FX 1973-86 FXD/DL/DS 1994-05 (not XL sport), and FXSTD 2000-on (45790-80, 45996-73)
- 24161 Allen head as above
- 9758 (D) Chrome FXWG, FLT, Softail 1980-on, and FXDWG 1993-05 (45858-77)

Fork Leg Assemblies



Fork Tube and Slider Assemblies

Fork tube and sliders come completely assembled for left and right sides. Includes hard chrome fork tubes, chrome or polished lower sliders, springs and all internal components installed.

FLT Assemblies

PCP	MM	Disc	Application
98101	41	Dual	1984-99 w/chrome sliders

FLST-FLSTF Assemblies

98103	41	Single	1986-99 (45915-86, 45916-86)
69733	41	Single	1986-99 w/chrome sliders
98104	41	Dual	1986-99
98105	41	Dual	1986-99 w/chrome sliders

FXST Assemblies

69734	41	Single	1984-99 w/chrome sliders
98117	41	Single	+4", as above
98118	41	Single	+6", as above
98106	41	Dual	1984-99
98107	41	Dual	As above w/chrome sliders



Chrome Complete Fork Tube Assemblies

Each assembly includes: fork tubes, caps, plugs, springs, o-rings and dampener valve. Stock length assembly. Sold each.

69727	FXST 1984-03 (24-1/4" tube)
69728	FLST 1986-99 (22-7/8" tube)



41mm FXST Chrome Bullet Leg Set 1984-99

Fits 1984-99 FXST model internals with single disc and 11" rotor. Features a ball milled design and includes an axle.

PCP	Description
51472	Set
59281	Axle only



Lower Fork Slider Sets

PCP	Application
51467	1984-99 FLHT/HR
51469	1984-99 FXST polished
51471	1986-99 FLST chrome
51489	2000-08 FLHR (41mm)

Fork Tubes

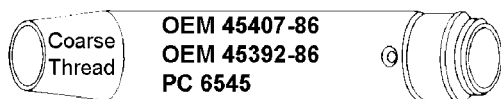

XL Models Late 1986-87; FXR Models with 35mm Showa fork late 1986-87 (except FXRT, FXRD, & Sport Edition).

Hard		
Chrome	Chrome	Length (45407-86)
6545	98514	Stock Length 23-1/4"
6546	98515	2" Over stock length
6547	98516	4" Over stock length
6548		6" Over stock length

FXRT, FXRD with 35mm Showa fork 1987 only

Chrome	Length
6546	Stock length 25-1/4" (45392-86)
6547	2" Over stock length
6548	4" Over stock length

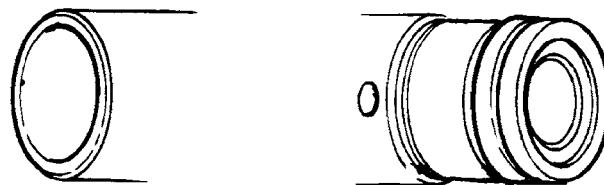

39mm Fork Tubes

Sportster and FXR models with 39MM Showa forks 1987-96 except 1992-on Hugger & FXRD, FXRT Sport Edition

Hard		
Chrome	Chrome	Length (45381-87)
6706	98500	Stock Length 23-7/16"
6707	98501	2" Over stock
6708	98502	4" Over stock
6709	98503	6" Over stock
	98504	8" Over stock

FXRS Sport Edition 1987-1993; FXRT 1988-1993 and 1987-93 FXRS Convertible

6707	Stock Length 25 3/8" (45393-87)
6708	2" Over stock
6709	4" Over stock



Full Lowering Kit

These kits include components to lower the front and rear end of Softail models. Each kit includes shorter damper rods, 1" shorter kickstand and adjustable rear shock lowering set. The front of the FXST is lowered 2.5" and 2" on FLST models. The rear is adjustable up to 1.5" on 2000-on models and up to 2" lower on 1989-99 models, when using stock shocks.

82092	1989-99
82093	2000-06

Note: When installing these kits you **must** check ground clearance and tire to fender clearance.

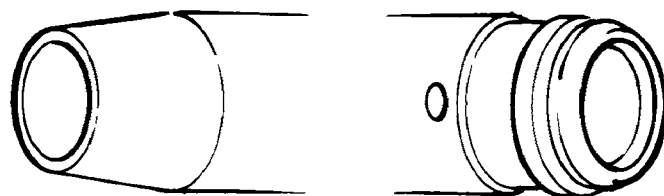

FXE, FXEF Models 1984-85; FXR, FXRS, FXRDG, FXRC Models 1984-86 (except sport edition)

Hard		
Chrome	Chrome	Length (45407-83)
6381	98510	Stock Length 23-1/2"
6382	98511	2" over stock (45392-83)
6383	98512	4" over stock
6384		6" over stock
6385		8" over stock

FXRT, FXRD Models 1983-86; FXSB 1984-85; FXRS 1985-86 (with sport package)

PCP	Length
6382	Stock Length 25-1/4" (45392-83)
6383	2" over stock
6384	4" over stock
6385	6" over stock



FXST Fork Damper Sets 1984-on

Will lower front forks 2.5" on FXST models. Use with stock fork springs.

PCP	Year
59282	1984-99
59283	2000-06

Fork Tubes

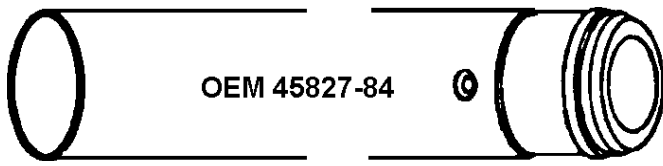

OEM 45827-84



OEM 45417-84

Heritage Softail, Nostalgia, and Fat Boy Models 1986-99

Chrome	Hard Chrome	Length (45930-86)
6395	98533	2" under stock length, (same as FLT)
6396	98534	Stock length 22-7/8"
6397	98535	2" over stock
6398	98536	4" over stock
6399	98537	6" over stock

FXWG 1984-86; FXST/C & DYNA WIDE GLIDE 1984-99

Chrome	Hard Chrome	Length (45417-84)
6391	98540	Stock Length 24-1/4"
6392	98541	2" over stock
6393	98542	4" over stock
6394	98543	6" over stock
98400	98544	8" over stock
98401	98545	10" over stock
98402	98546	12" over stock

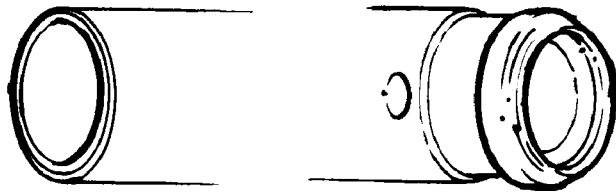

FLT/HT/C, and FLHS/Road Kings 1984-96

Chrome	Hard Chrome	Length (45827-84)
6395	98533	Stock Length 20-7/8"
6396	98534	2" over stock
6397	98535	4" over stock
6398	98536	6" over stock
6399	98537	8" over stock



98415

FXST, FXDWG, FXSTD 2000-on (41mm)

Chrome	Hard Chrome	Length
98414	98558	Stock length (45417-00)
98415	98559	2" over stock
98416	98560	4" over stock
98417	98561	6" over stock
98418	98562	8" over stock



98408



98422

FLT/HT Touring Models 1997-on without Fairing and 1997-01 with Fairing

Chrome	Hard Chrome	Length
98408	98552	Stock length (45890-97)
98409	98553	2" over stock
98410	98554	4" over stock
	98555	6" over stock
	98556	8" over stock

FLSTF, FLSTC 2000-on (41mm)

Chrome	Hard Chrome	Length
98420	98564	Stock length (40930-00)
98421	98565	2" over stock
98422	98566	4" over stock
98423	98567	6" over stock
98424		8" over stock

Attention!!

These fork tubes have been manufactured and tested for exact fit and application per model. It can be difficult to identify the front end assemblies because they may not always be the original equipment. Before installing, compare old and new tubes. Be sure the stock top plugs fit into the new fork tubes. To avoid scratching the chrome, we suggest that the tubes be lightly rubbed with oil before installing into fork legs. Be absolutely sure you have the right tubes before you install them.

No fork tubes can be accepted for return that are scratched or damaged due to improper installation or handling.

Fork Springs



Fork Tube Spring Sets

Exact replacement for the OEM's. Made from high tensile strength wire for long service life. All fork springs sold in pairs. For more complete fork spring applications, check your factory parts book. Measurements provided are free length.

PCP Application (Free Length)

6712	1976-on FX, FXE, XLH, XLCH (45408-75) (19-3/8") 35mm
82074	1984-87 FXR-FXRS (45408-84)
6718	1988-94 FXR/S (45376-87)
82100	1995-on FXD (45941-95)
6722	1984-99 FXST, FXSTC (46048-84) (21")
82077	2000-on FLST (45931-00)
82078	2000-on FXST (46048-00)
82079	1983-96 FLT (45853-83)
82080	1997-on FLT (45892-97)
82081	1984-87 FXRT (45384-83)
82082	1986-99 FLST (45931-86)



82029



Cruise Control Front Fork Lowering Kit

Kit lowers front end by 1" or 2" decreasing initial ground clearance. For maintaining proper balance geometry it is recommended that the rear end be lowered by an equal amount.

PCP Size Application

82027	35mm	FXR 1982-86, FX 1984-86, XL 1984-87
82028	39mm	All Dyna (except Wide Glide); XL 1988-07 (except 92-03 Hugger and 1200S); FXR 1987-94
82029	41mm	Dyna Wide Glide 1993-06; FXST 1984-06; FXWG 1980-86; FL 1978-86, FLH/T 1980-01 and FLHT/FLTR 2006-07, FLHR 2002-07, FXWG 1980-86, FL/FLH 1978-86



Progressive Suspension

Fork Springs by Progressive Suspension Inc.

These springs eliminate front end sag, reduce nose dive under braking, improve stability and increase rider comfort.

82000	35mm 1982-87 FXR, 1971-87 XL, 1971-86 FX
82001	39mm 1987-94 FXLR, 1988-03 Sportster, except Hugger and 1200S, and 1988-94 FXR/S (except Convertible™, Sport Edition & FXRT)
82002	41mm forks on all 1980-86 Softails and FXDWG, 1980-86 FXWG, 1980-01 and 2006-07 FLHT, FLTR and 2002-07 FLHR
82003	39mm 1987-1993 FXRS Sport /Convertible Edition, 1988-93 FXRT and all dyna except FXDWG
82004	39mm XL Hugger 1992-03



Fork Springs

Progressively wound springs are made using the finest drawn spring wire. Eliminates front end sag, reduces nose dive under braking and improves stability.

PCP Application

82083	35mm 1975-87 Showa
82085	39mm 1988-91 Showa XL, FXR
82084	39mm 1988-91 Showa FXRS

1984-99 FXST Internal Fork Hardware Kits

Includes springs, damper kits, seal kit, washer, inner cap tube plug and top taper fork cap.

82105

Neck Cups



Chrome Smoothie Neck Cup Kit

Kit includes races, 1" bearings and dust cover set for Big Twins.

59114



Timken Sealed Neck Bearings

Bearings feature built-in rubber seal at contact to race. Available as a complete set with chrome cups or as update to models where races are built-in frame.

27184 Chrome cup and sealed bearing kit 1949-88, BT includes 2 chrome dust covers

15517 2 Sealed bearings and 2 chrome dust covers fits FXST-FLST, FXR 1989-on, FLT 1980-on, XL 1982-on and Dyna 1992-on

15518 Sealed bearing (each)



XL Fork Springs

PCP	Application (Free Length)	MM
6712	1976-on XLH, XLCH (45408-75) (19-3/8")	35
82075	1984-87 XLS-XLX (45907-83)	35
6718	1987-94 (not Hugger) (45376-87) (20-1/4")	39
82091	1992-96 (45372-92)	39
82098	1997-03 (45376-97)	39
82104	2004-on (45376-04)	39



BT Neck Cup Assembly 1948-85

Complete kit includes chrome neck cups with races and a chrome top nut.

PCP	Description
27214	Complete kit
4799	Cups with bearings (48315-48)
27213	Zinc cup set (48311-60)
2455	Races (48315-60) (each)
15515	Bearings (48300-60) (each)
5755	Chrome dust cover (48365-48A & 48361-60) (set)
12589	Zinc cone nut (48332-48B)
12590	Cone nut FLT (48333-80)
12625	Chrome top nut with lock 1960-on (45718-60)
5398	Black top nut with lock 1960-on (45718-60)
13733	Lock tab (45717-63) (5 pack)



Lowboy Fork Lowering Kits

Kits have progressively wound springs that resist bottoming out. Installation requires minor disassembly to lower the front forks 1 1/4" or 2" depending on the spacer used. Each kit includes springs, spacers and hardware. Stock ground clearance is maintained with forks fully compressed. May be converted back to stock by reinstalling the OEM springs.

PCP	Application
82124	(41mm) FXST 1984-on, FXWG 1980-89
82125*	(41mm) FLHR 2002-08 (54614-05)
82126*	(41mm) FLHT (not FLHR) 2006-08 (54628-06)
82127**	(39mm) XL 2004-08 (not 883L or 1200N)
82128	(39mm) FXR & Sportster 1987-95
82129	(35mm) FXR-FX-XL 1975-87, Showa & Kayaba

*To be installed only on models with low profile shocks

PCP #65314 or OEM #54631-02B

**XL883/R & 1200R must also have low rear shock kit

OEM# 54750/54731-04, or 54733-04 installed



Fork Stem Bearing & Race

Replaces OEM 48300-60. Use on all 1948-on FL, 1971-on FX, and 1982-on all XL's.

15515 Bearing

2455 Race (48315-60) (each)

Neck Cups



40708



40716



40709



40707

BT 3 Deg. Raked Fork Neck Cup Kits 1949-87

Replaces existing removable cups and provides a 3 degree rake when installed. Kits include 2 cups, 2 bearings, 2 races and other pieces as shown.

40708 BT 1949-87, chrome

40709 As above, with external fork stop

"Raked" Fork Neck Cup Set

Replaces existing removable cups to provide 3 degree rake when installed. Kit includes cup set, bearing set and dust covers with instructions.

PCP Application

40707 1949-87 BT (stainless)

40716 1988-on XL, 1990-05 FXD



40715



40718

Raked Fork Neck Cup Set

Replaces removable cups to provide a 3 degree rake. Set includes cups, bearings, and dust covers.

40715 1988-on FXST, 1990-on FXDWG chrome

3 Degree Raked Neck Kits

Includes chrome cups, bearings, dust cover, stop tab and longer stem. Longer fork tubes required for installation.

PCP Application

40718 1988-on XL

40719 1991-04 FXD

Chrome Mega-Neck Cup Set

Features 1" ID bearing set with large OD on the outer race which will provide 1.68 times the radial capacity and 1.57 times the axial capacity of a conventional bearing. Kit includes chrome cups, bearings, races and 2 dust covers.

40720



Neck Cups



Universal Fork Stop

Mounts to triple tree.
40050



Chrome Frame Cups and Bearings

74-80 Neck Cup includes 2 chrome cups (48311-60); 2 races; 2 (48300-60) bearings. Use on FL, FX 1948-85, FXWG 1980-86 and FXST, FLST 1984-88.

4799 Complete kit
548 Chrome cups with races only



Smooth Neck Cup Set

Features built-in stop and includes races and bearings.
59924

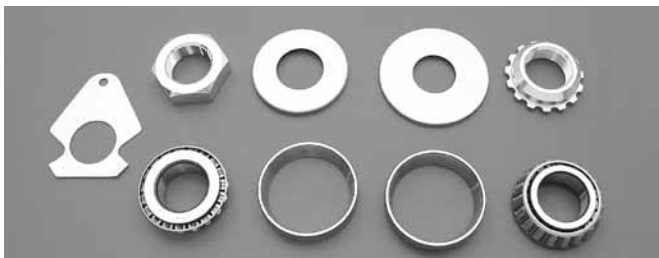

FLT Neck Bearing and Hardware Set

59934 1980-on FLT



Chrome Internal Fork Stop Kit

Includes pieces for installation on Big Twin and custom frames which accept press-in neck cups. Kit allows choice of 35 or 45 degree turning radius.

Complete Kit	Degree
40711 1949-87 BT	35 and 45

45° Fork Stop Kit

These kits do **not** include races, bearings or neck cups.

40717 1988-on FXST, FXDWG	45
59925 1982-94 FXR	45



Chrome BT Neck Cup Kit

Features built in fork stop on lower cup to accept 1988-99 FXST lower fork stem with integral stop. Kit includes chrome upper and lower cups with races bearings and dust shields.

40714	Kit
15515	Bearings 1960-on (sold each)
5755	Chrome dust shields 1949-88



72184

Stem Nut and Lockwasher Kit

Precision machined stock stem nut and stamped steel lockwasher fits 1949-on FLH and 1980-on FXWG, FXST. Fits OEM 45718-60 nut and 45717-63 lockwasher.

5398	Zinc
72184	Chrome

Fork Trees



Chrome Top Tree FXST, FXDWG 1989-on

This top tree has an updating design to replace 45672-80A. **59200**



FXST Style Chromed Fork Clamps 1984-99

Top quality fork clamps available in the FXSTC style, chrome plated. Lower bearing and dust shield included. USA

- 69504** Set for FXSTC
- 69505** Lower tree only (45640-88B)
- 69506** Top tree only 1984-08 (45672-80B)

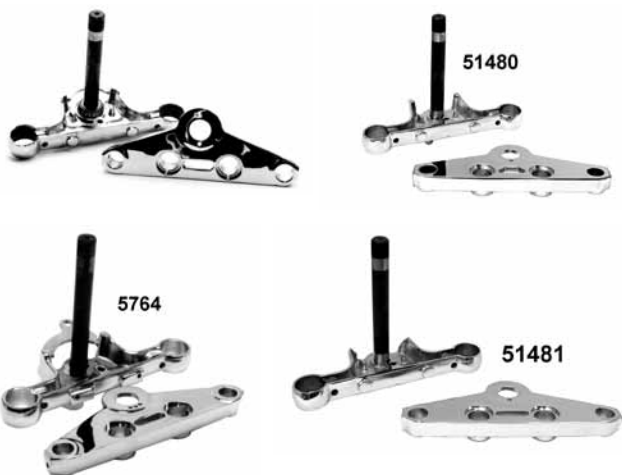

Chrome FXWG, FXST Triple Trees

Accepts 41mm fork tubes. Bottom tree features built-in rake and rounded edges. Trees use PCP# 4822 rubber bushing and # 1358 headlamp bracket, sold separately. Replaces 45672-80 upper, and 45665-80A lower stem and bracket.

PCP Application

- 5764** 1980-87 FXWG/FXST (set)
- 59200** 1980-87 FXWG/FXST Chrome top only
- 5766** 1980-87 FXWG/FXST Chrome lower only
- 51439** 1988-99 FXST (set)
- 51480** 2000-08 FXST (set)
- 51481** 1992-05 FXDWG (set)



Chrome FXST Lower Fork Stem

Accepts 41mm fork tube and fits FXST or neck cups with built-in stops.

- 51438** 1988-99 (45640-88B)
- 69518** 2000-08 USA (45640-00A)



Replica Chrome Forged Steel Triple Tree Set

Trees include pressed-on lower bearing, dust shield set and upper bearing and cone nut.

PCP Application

- 51461** 1960-84 FLH
- 51462** 1980-87 FXWG, FXST
- 51463** 1988-99 FXST
- 51464** 1986-99 FLST
- 51465** 1992-05 FXDWG
- 51466** 2000-08 FLST



Top Nut With Chrome Cover

- 44082** Replaces 4453

Fork Trees



51422



51477



51478



51426



51427

41mm Billet Chrome Triple Tree Sets 1949-on
Available for BT 1949-on when using external fork stops in stock or 3 degree rake and include stem and top nut. Not for FXDWG.

PCP	Rake
51425	Stock
51426	3 Degrees
51427	5 Degrees

Taper-Top Socket Fork Caps

Unique tapered style uses hex wrench for installation, no more marred chrome from wrenches, chrome, pair.

40703 FLH-FXWG Wide Glide 1977-99



40703

Smoothie Billet Triple Tree Set BT 1949-99

Features hidden stem nut top tree for use with 41mm fork tubes. Kits include riser bushings and stem hardware.

PCP	Description
51422	Stock rake
51477	3 Degree rake
51478	5 Degree rake
51479	Stock FXDWG 1991-on
40702	Top plugs 1949-76
40703	Top plugs 1977-99



59852



59853



59853 Installed



51458

Chrome Deuce Triple Tree Set 2000-on

Includes upper and lower tree for Deuce 2000-on.

51458

Chrome Billet Tree Sets

PCP	Rake	Style
59852	3°	Smooth
59853	6°	Druid

Fork Trees



Chrome Billet Forged Triple Tree Set

Tree set fits on 41mm tubes and includes a 1" stem, hidden top fork tube caps and collet clamp at top and lower tree, and headlamp mount.

59226



FXSTS Springer Billet Top Trees

Fits 1988-on FXSTS models to allow risers or one piece bars with 3.5" centre distance to be installed.

PCP Application

59977 1988-05 FXSTS

59978 1997-03 FLSTS



Heritage Style Triple Trees 1986-99

These replacement triple trees are as stock and accept the Heritage/Fatboy trim and headlight. For 41mm fork tubes. Direct replacement for 1986-99 models.

51409 Set, chrome

51408 Set, chrome top and black lower

51403 Upper tree (45456-86)

51406 Bottom tree, chrome (45605-88)

51407 Bottom tree, black



FLSTC Style Fork Clamps

Top quality fork clamps available in the FLSTC/F/N style, **painted black**. These clamps are ready for OEM tins or our chromed versions #45701. Lower bearing and dust shield included with lower tree. These trees fit 1986-99 models. Stock Heritage tins will fit, or Preston's #45700 chrome.

69507 Set for FLST 1986-99 (45605-88 & 45456-86)

69508 Lower tree only (45605-88) black

51407 As above, Preston

69509 Top tree only (45456-86B) chrome

Fork Clamps for FXDWG 1992-99 (Stock Finish)

69510 Set for FXDWG (45679-92 & 45672-80)

69511 Lower tree only (45679-92)

69506 Top tree only (45672-80B)

FLST 2000-08

69517 Black lower tree only (45605-00A)

Chrome Billet Fork Stops

Mount to custom triple trees under lower bearing.

73646 FXD (stainless steel)

73647 BT 1948-99

Wide Conversion Kit



FXD-XL Narrowglide Conversion Kit

Fits FXD-XL 39mm models and includes upper and lower triple trees, stem, stem nut, fork stops, axle, axle spacers and fender spacers. For use with 1984-99 FXST/FXDWG 41mm fork leg assemblies and 1984-99 narrow glide 19" or 21" wheel assembly with aluminum hub and front fender. Accepts OEM 11.5" rotor and caliper (custom brakes may cause interference with laced wheels). Measures 4-15/16" between fender mounts. For front wheel speedometer operation, replace left side axle spacer with speedo drive unit.

PCP Description

51487 Kit
4071 Speedo drive

Fork Stop Tabs

73735 1982-03 XL
73736 2004-on XL
73737 1991-on FXD



Preston's Wide Fork Conversion Kit

Give your XL or FX the Wide Glide look using this kit's chrome complete triple tree set. Required wheel spacer included.

PCP Application

51417 XL, FXD, FXR w/39mm forks, single disc 1988-99 (not for FXLR)

51418* FXD, FXR w/39mm forks, single disc 2000-03

*Note: 2004-on models require purchase of caliper and rotor kit #90142. 2000-03 require the purchase of 1984-99 style rotor. 2005-on models require #27403 spacer kit for 1" axle.



Disc Hub Spacer Kit

This kit fits fork conversion kits for 39mm Showa front forks 1988-99. 1.440" Thick (for kit #51417)

43105



19" Wheel Conversion

For customizing flexibility, this kit adapts 19" narrow glide wheels to wide glide front ends. With the custom spacer and the specially designed axle, you can mount any dual disc wheel to any wide glide front end. Kit includes 1" aluminum disc spacers, axle, axle spacers and all mounting hardware. Spacers are polished and chrome plated. Axle and steel spacers are cadmium plated.

53501 1984 - 99 FXWG with 1 spacer

43107 Extra spacer for #53501 to use dual rotors

53502 FXWG 2000-03 with 1 spacer

43119 Extra spacer for #53502 to use dual rotors

49mm Fork Components for FXD 2006-on

PCP Item
69763 RH Slide assembly (45947-06)
69764 LH Slide assembly (45948-06)
51483 Polished fork tree set (46311-07)
12651 Top cone nut (48307-06)
63054 Lower dirt guard (48198-06)



Fork Stems



Cast Lower Tree Application Chart

PCP	Application
51413	1984-87 XL, 1984-87 FXR, FXRS, (35mm) Chrome with fork clamp cover holes (47693-84)
51414	1984-87 XL, FXR,FXRS, (35mm) Black with out fork cover holes (47693-84)
59279	1984-86 All FX except FXWG, FXST, FXR 1984-87 FXR, FXRS (35mm) (45608-84)
59280	As above, chrome (35mm) (45608-84)



39 mm Lower Tree Applications

Black except where noted.

PCP	Application
51453	1988-94 FXR-FXRT, 1988-03 XL 1200, 1995-03 XL 883 (45563-87)
51454	1987-94 FXLR, 1996-03 XLC (polished) (45561-87)
51455	As above, chrome (45561-87)
51457	1990-05 FXD-FXDL (45598-90A)
51460	As above, chrome (45598-90A)



Chrome Triple Tree Sets (39MM)

Set includes upper and lower trees to fit 39mm fork tubes as stock on 1990-on models.

PCP	Application
21648	2004-on
51451*	FXD 1990-05 (45023-02)
51452	XL, XLX 1987-03
21648	XL, XLX 2004-on

*Requires use of bearing 48300-60



39mm Chrome Lower Tree FXD-FXDL

51460 1990-05 (45598-90A)

Weld On Fork Stem Locks & Stops

Lower fork stem lock part allows repair or adaption of tee. Must be welded on.

27019 1986-on FLST



Steering Stabilizer Kit

Includes brackets and adjustable round body dampener piston. Made in Japan

PCP	Fits	Fork	Year
40721	FXST-FXWG BT	41mm	1980-99
40722	FXST	41mm	2000-on
40723	FXD	39mm	1991-99



Upper Bracket Cover

Fits 1988-on XL, FXD 39mm forked models when using a custom bottom mount headlamp.

62804

Fork Stem Parts



Late Cone Cover Nut

Cad plated stock type cone cover nut.

12589 1949-99 BT w/steering damper (48332-48B)

12647 2000-on FXSTD (48324-00)

12590 1980-on FLT (48333-80)

12651 2006-on FXD (48307-06)



35 mm Upper Triple Clamps

Fits FX models 1973-1986, FXR models 1982-1986 and XL models 1973-1986

59276 1973-86 cast (45738-73)

59277 1973-86 polished (45738-73)

3260 1973-86 chrome (45736-78B)

39 mm 1988-03 FXR, 1988-08 XL & 1991-05 FXD, FXDL

27207 Chrome (45739-87)

39 mm 2004-on XL

21732 Chrome (45966-04)



Tweak Bar

Fork Brace is made of polished alloy, 2 piece for easy installation.

PCP Application

4798 35mm Showa and Kayaba forks, FXE, XL, FXR 1973-87

59284 41mm 1949-84 FLH, 1980-on FXWG-FXST

59285 41mm As above, chrome

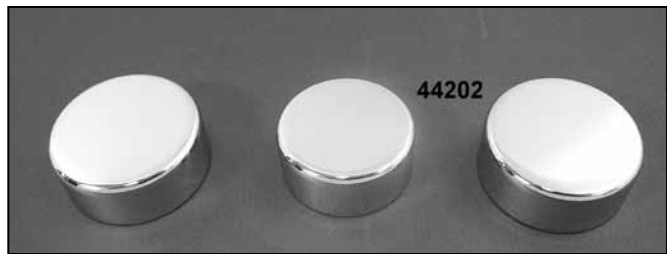

Chrome Fork Stem and Tube Nut Covers

Fit over stock stem nut and held in place by socket set screws. PCP# 2221 screws in stem, #44202 includes 2 fork tube cap covers and 1 stem nut cover. PCP# 44200, 44201 and 2221 are sold each.

PCP Fits

44202 39mm forks, 3 piece. set. FXRS-SP 1987-on, FXLR 1988-90, FXR 1988-90, XL 883-1200 1988-on

44200 35mm forks FX-FXR 1971-87, XL 79-87

44201 39mm forks FXR, 87-up, XL, 1991-93 (45668-90)

2221 FXWG-FXST, 1980-99 screws in stem (45670-80)

72058 Colony as above



Stem Nut and Lower Cone Nut Set

Thin profile of cone nut allows use of outer covers and cowls.

12650 Kit

1679 Acorn nut only

Chrome Upper & Lower Dust Cover Set

Use on all FX-FL models 1949-88. XL models 1977-88, when a 1" stem is used. Use on Glide Forks if threaded nut is not used.

5755 (48365-48A, 48361-80)



Fork Covers



Forged Aluminum Fork Brace 35MM

This top quality brace adds rigidity to fork tubes, by clamping to the fork seal area of lower sliders. Designed to fit FX, FXR, & XL models with Showa Forks. Precise machining with a high lustre.

27081 Chrome



Upper Fork Slider Covers

Chrome covers for upper fork legs. Fits 1980-on FLT, FLHT, FLHR, FLHX, FLTR; and 1986-on FLST/C/F, FLSTN (not 2007 FLSTF).

45710 Pair (45963-97)

66141 T/L as above



Chrome Slider Covers

Fits FLT1980-on, FLSTC/F/N 1986-on.

PCP	Size
45702	Stock chrome (45964-86)
45703	2" Chrome
69552	Stock stainless
45707	2" stainless



Stem Nut

Fits FLST, FXR, FXD and XL 1986-on.

9976 Zinc bolt and washer

9978 Chrome dome bolt and washer 5/8-18 threads



Chrome Stem Cap

With 1/4-20 stud.

9977 1986-on FLST, FXR, FXD, XL

72058 1980-99 FXST/N/F, FXWG



Decorative Fork Boot Covers

These covers are chrome plated and install without disassembly of fork. No tools required.

PCP	Year/Model
69526	1980-86 FXWG, 1984-on FXST/C/B, 1993-05 FXDWG (45415-82)



Chrome Wiper Boot Covers

These covers are die-cast for a snug-fit over the stock rubber fork-wiper boot. Fork must be disassembled for installation. Sold in pairs.

2218 FX 1976-87, XL 1975-87, Showa (45350-84T)

45713 FXST 1984-90

45822 FXST-DWG 1991-on

45716 FXST-DWG 1991-on Tall

45717 FXST-DWG 1991-on Cone

45714 FXR 1988-on, 39mm

45718 FXD 2006-on, 49mm



Rubber Fork Boots

These rubber fork boots have an exceptional resistance to flexing, tearing, weathering or cracking, and this design improves the sealing and wiping action. Sold in pairs.

PCP	Fits
5011	FXWG & FXST models (except FatBoy & Heritage) from 1980-on (45420-80)
641	35mm Showa forks from 1975-87 (45404-75T)
14096	Dust seals only, 1988-on FXR's and 1991-05 FXD (45401-87)

Fork Parts



39mm Fork Boot Dust Shield Kit

Fits 1988-on XL, 1987-94 FXR, 1991-05 FXD.

40040



T/L Chrome Lower Front Fork Dust Covers

Chromed billet dust covers are made from 6061-T6 aluminum and replace the stock black rubber slider seals on 1984-89 FXST, FXST/B models, fxstc 1984-on, 1991-05 FXDWG and 1980-86 FXWG models.

64298 45243-00



64323

Chrome Fork Boot Covers

Chrome custom fork boot covers easily install without the use of tools or disassembling the front fork.

PCP Application

64323 T/L 2006-on Dyna (46590-05)

45729 Preston, as above



FXSTD Chrome Lower Triple Cover 2000-07

Use this cover to dress up the unfinished underside of lower triple tree. Includes mounting hardware.

64263 66021-00



Billet Chrome Fork Slider Dust Covers

Chrome dust covers for 2006-on Dyna. Does not fit with Screamin Eagle chrome fork braces 46634-06 or 46595-06.

64308 46889-06



Narrowglide Chrome Lower Triple Tree Covers

A 3-piece chrome cover assembly designed for easy customizing of the black painted lower triple tree on all 1986-on FXR and Superglide, without having to dismantle the forks. Easy installation. Ideal for any 1971-on XL or FX "narrow-glide". 35mm only.

4531 3 piece kit

2472 1 piece cover XL 1970-on, FX 1971-87 (45751-71TA)

8757 Button head screw kit



Chrome Lower Triple Tree Cover

Fits 39 mm forks 1987-on. Designed for easy installation.

45428

Fork Parts



41mm Damper Valve Set 2000-on

Allows accurate damping of oil flow.

59447



Lower Damper Tube Springs (Pair)

PCP Description

- 13215** FLT 1980-97, all FXWG, FXST/C 1984-96, FXDWG 1993-96 (43855-77)
- 13222** FLSTC/F/N 1987-97 (45933-86)
- 13153** FXRS-SP, FXLR 1987, all FXR 1988-94, Dyna 1991-on, FXDL 1993-96, FXD, FXDS-CON 1995-96 (45374-87)
- 13220** XL,FX, 1983-on, FXR 1983-87 (45382-83)



Damper Tube Rings (Sold in 4 Packs)

PCP Description

- 13801** All FLT 1980-96, FLSTC/F/N 1980-97, FXDWG 1993-96, FXST/C 1984-97 (45859-77)
- 13802** FXRS-SP, FXLR 1987, all FXR 1988-94 (45462-87)
- 13803** Dyna 1991-on, FXD 1995-96, FXDL, FXDS-CON 1993-96 (45460-90) (35mm)
- 13804** 35mm 1975-86 (45412-75)

Damper Tube Screw

Replaces 45405-75A on 1975-on Showa forks for FX, FL, 1980-on FXWG-FXST.

24537 Sold in Pairs

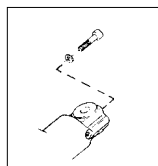

Damper Tube Washers (10 pack)

PCP Description

- 79388** XL Showa 75-on, FX 76-on (copper) (45406-75)

Lower Damper Tube Stop (Pair)

PCP Description

- 16514** FXST 1984-97 FLT 1980-97, FLSTC/F 1987-97, FLSTC/F/N 1987-97 (45834-77)
- 16508** XLH-FXR 1984-on (45403-84)
- 16512** All FLT 1997 (45803-97)
- 16510** Dyna 1991-05, FXD 95-96, FXDL 93-96 (45361-90)
- 16511** FXRS-SP, FXLR 1987, all FXR 1988-94 (45463-87)

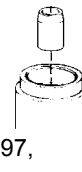

Fork Drain Screws and Washers

PCP Description

- 24538** Showa 1976-on (45790-80) (10 pk)
- 24539** FXWG 80-on (45858-77) (pair)

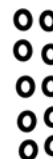

Drain Screw Fiber Washers (10 pack)

- 25205** Showa 1976-on (45986-75)



Front Fork Tube Spacer (10 pack)

For BT 1987-on & XL 1988-on

- 11712** 45377-87

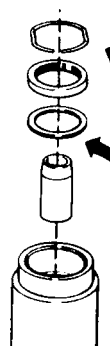

Fork Seal Retaining Rings

- 11093** 1977-on FL-FXWG (45842-77) (10 pk)
- 79500** 2006-on Dyna, 2001-on V-Rod (46513-01) (6 pk)

Slider Washer

Fits 1949-on FL Wide Glide type fork assembly.

PCP Fits

- 11547** 1987-on FXST (45865-84) (pr)

Fork Parts



Fork Bushings

Top quality replacement bushings.

PCP Description (Pairs)

- 18574** XL-FXR 1990-on, upper FXRT 1984-87 (45413-84)
- 18575** XL-FXR 1984-90, lower FXRT 1984-87 (45416-84)
- 18583** FXST, upper FLT 1984-on, FLSTN, FLSTC/F/N 1993-96 (45940-84)
- 18582** FXST, lower FLT 1984-on, lower FXDWG 1993-96 (45866-84)
- 18577** FXRS-SP, FXLR 1987, all lower FXR 1988-94, lower Dyna (not FXDWG) 1991-92, XL 1987-97 (45465-87)
- 18576** Upper FXDL, FXDS-CON, FXD 1991-05, XL 883-1200 1987-on (45461-87)



Fork Damper Tube Kit

Kit for 2 sides includes: damper tubes with rings, screws and washers, lower stops, slider seal washers and retaining clips.

PCP	MM	Application
40013	41	FXST-FXWG 1984-99
40051	41	FXST 2000-on
40014	41	FLST1986-99
40046	41	FLT 1983-96
40018	35	XLH 1984-87
40041	39	XLH 1988-93
40042	39	XLH 1994-96
40043	39	XLH 1997-on
40045	39	FXR 1987-93
40052	39	FXD 1995-05



40005



40009



40048



40056



Fork Damper Tubes (sold each)

Tube rings included if required, but does not include bolts/washers.

PCP Description

- 40002** FXST 1984-99 (45418-84)
- 40004** XL 1984-87, FXR 1984-86 (45913-84)
- 40005** FXR 1987-on (45924-87)
- 40049** XL 1997-03 (45925-97)
- 40048** XL 1994-96, FXD 1994-05 (45925-94)
- 40006** XL 1988-93 (not 92-* Hugger) (45925-88)
- 40009** FLSTC/F 1986-99 (45932-86)
- 40047** FLT 1983-96 (45857-83)
- 13801** Nylon ring 41mm BT 1977-on (45859-77) (4 pk)
- 13802** Nylon ring 39mm XL, FXR 1987-on (45462-87) (4pk)
- 13803** Nylon ring 39mm Dyna 1991-05 (45460-90) (4pk)
- 13804** Nylon ring 35mm 1975-86 (45412-75) (4pk)

Fork Damper Tubes

PCP	Application (Pairs)
40056	FXST 2000-06 (45418-00)
40057	FLST 2000-06 (45932-00)
40058	FLT 1997-05 (45891-97)
40059	FXSTD 2000-07 (46176-00)



59282



59283

FXST Fork Damper Sets

Use with stock fork springs to lower front forks by 2.5" on FXST models.

59282	1984-99
59283	2000-06

Glide Axle Leg Caps

Cast Alloy for Glide lower legs, FLH type.

PCP Years

- 5029** 1977-99 plain (45832-77)
- 44039** As above, chrome
- 44040** Polished 2000-on



Fork Plugs



XL-FXR 39mm Chrome Fork Tube Plugs

PCP	Application
9913	L1988-on XL-FXR, Colony (each) (45996-87)
9914	As above, domed style (each) (45996-87)
51017	1988-on XL-FXR, flat top (pair) (45996-87)
51018	As above with filler hole (pair) (45990-88)



Glide Fork Plug Kit

Kit includes fork tube plugs and matching top filler cap plugs. Kit available for 1977-on FLH-FXWG and FXST. Big Twin Glide models are Showa type.

51016 1977-on Showa FL-FXWG-FXST



Chrome Top Fork Tube Nuts

1794	FL Glides 1977-1/2-on (pair)
1176	FXWG 1980-on, FXST 1984-on. (45419-80) (pair)
5485	Fork tube bolt replaces the original equipment of MID 1985-87 XL, FX (each)



Narrow Glide Axle Cap

Alloy finish.

PCP	Application
44057	Left 1984-87 XL, FX (45410-84)
44059	Right 1984-87 XL, FX (45994-84)



E-Z Fill Fork Tube Top Plugs

Chrome plugs feature small oil cap built in to fork tube top plug which will allow fork oil change/fill without removing top fork cap. Pairs.

51018 XL, FX 1988-on 39mm EZ fill



Chrome Wide Glide Fork Tube Plugs

547 FL Glide L1977-on (45838-77) (pair)



Chrome Fork Tube Bolt and Washers

Flat top bolt and chrome washers sold separately.

9912	Bolt and washer for FL, FXWG, FXST 1978-on (5710, 45419-80) (1bolt & washer)
9964	Washer only for FL, FXWG, FXST 1978-on (5710) (pair)



Allen

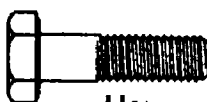

Hex

Lower Stem Pinch Bolts

Offered in chrome allen or zinc finish hex caps. Chrome allen set for FXWG-FXST includes head light bracket screws, XL set includes screws for side of tree.

PCP	OEM	Type	Fits
24017	4411	Hex	1973-86 FX-XL, zinc
24018	4729	Hex	1949-on FL-FXWG-FXST, zinc
9803	4729	Hex	As above in chrome
24019		Allen	1973-86 FX-XL, chrome
9782		Allen	1949-on FL-FXWG-FXST, chrome



Fork Tube Plug (Each)

Chrome plated, chopper style fork tube plug replaces 45419-80. Complete with 5710 washer. Fits FL, FXWG, Softail 1978-on.

72311

Fork Parts

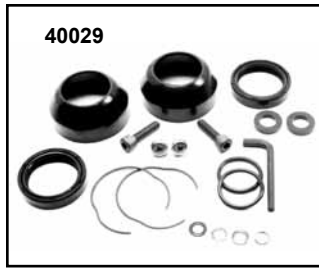

Preston Deluxe Fork Seal Rebuilding Kits

Kits include all pieces shown as appropriate for each application.

PCP	Application
40029	41mm FXST 1984-on
40030	41mm FLST 1986-on
40033	39mm Showa 1988-05
40034	35mm Showa 1984-87

Preston Fork Slider Seals in Pairs (For 5 packs see quick reference section 18)



For Sportster®, FX and FXR Models

PCP	Fits
5751	Sportster® 1984-87, FX and FXR models from 1983-86 with 35mm Showa forks (45387-83)
14100	Sportster 1988-on® and FXR models 1987-on, FXD 1991-05 with 39mm Showa forks (45378-87)

For FL, FLT/FLHT, FXWG and all Softail® Models

Fits FLT/FLHT, FXWG and all Softail® models from 1984-08.
14101 45875-84 (41MM)



Preston Fork Gasket & Seal Kits

PCP	Fits
5752	FLT, FLHT, FXST 1984-08 (6 pieces)



79830

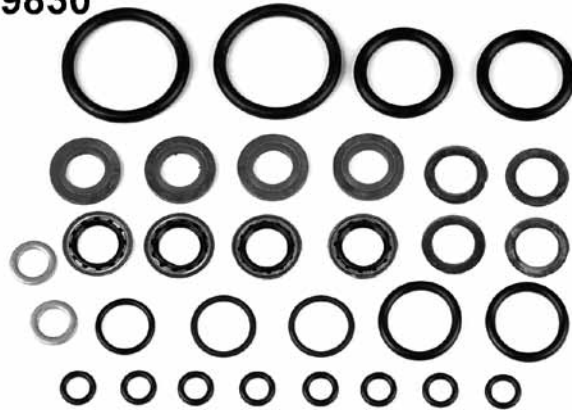

James Air Control O-ring and Seal Kit

Kit includes o-rings and seals needed to repair a leaking air control system. Fits 1984-92 FLT and 1984-92 FXR models with air control front forks.

79830 (45849-84-K)

James Fork Seals and Kits

Fork Oil Seals			
PCP	OEM	Fitment	U/M
79364	46175-00	FXSTD 2000-on	2 Pk
79365	46514-01	Dyna 2006-on	2 Pk
Fork Oil Seal Kits			
79805	45849-84	FXST, FXWG, FLT 1984-08	Kit
79806	45849-84-A	FXR/s/t, FXEF 1984-03, XL 1984-87	Kit
79807	45849-87	FXRS 1987-03, Dyna 1991-05 XL 883-1200 1988-91 (39mm)	Kit
79834	45849-96	XL 1996-09	Kit
79827	45849-00	Softail & Deuce 2000-09	Kit
79832	45849-06	Dyna 2006-09	Kit

Domed Allen Caps

Fits 1978-on FXWG 41mm forks.

51027



Fork Parts



Sportster Neck Cup Conversion 1982-on

Two chromed cups, two tapered bearings and chrome top dust shield. 1982-on are for stock replacement.

PCP Description

27212* Kit with 2 bearings and 2 shields

15515 Bearing only (sold each)

***Note: Does not include neck cups**

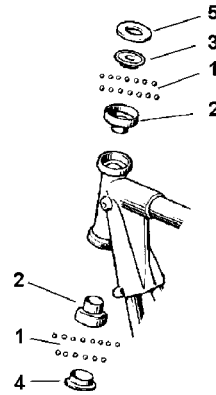

(5) XL Dust Shields (Zinc)

Bearing dust shields for XL's 1982-on.

PCP Fits

5760 Upper (48361-80)

1159 Lower (48365-48A)



8757 Button head screw kit for fork top tree & lower bracket chrome cover XL 1952-on, FX 1971-on

King Kone Tapered Dust Boot

Chrome billet alloy boot have built-in o-ring to help sealing. Internal threads screw onto billet legs with threaded top.

59679



Tube Cap Washer

Replaces 45997-73 on all FX-XL-FXR 1973-on Showa & Kayaba fork legs.

9964 Pair (zinc)



Acorn Type Fork Stem Nuts

Chrome plated.

1783 1971-85 FX-FXS-FXR and XL 1978-on

Fork Tube Plug Wrenches

Heat treated socket wrench comes in two styles, flat top style and domed top style. Designed for easy removal and installation of stock 1-3/8" top fork tube plugs. Installed o-ring eliminates damage to top of plug. Black oxide finish.

PCP Application

72317 1-3/8 Hex flat top plugs

72319 1-3/8 Hex custom dome plugs and will also fit stock and Colony Knucklehead rocker arm shaft nuts



Fork Tube Bolt

Custom chrome plated MID 1985-on XL, FX, coarser thread.

5485 Each

Mirrors

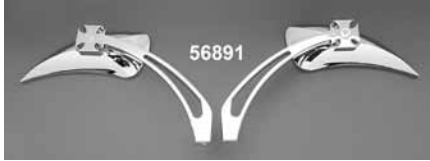
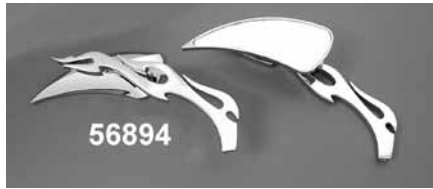
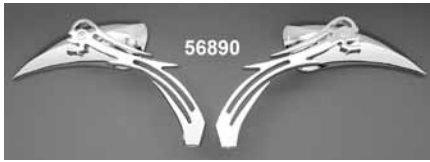

Chrome Billet Mirrors

PCP	Mirror	Stem	Fits
56890	Tear drop	Skull	Set
56891	Tear drop	Maltese	Set
56892	Tear drop	Diamond	Set
56893	Tear drop	Smooth	Set
56894	Tear drop	Flame	Set
56895	Spike oval	Smooth	R/L (each)
56896	Spike oval	Diamond	R/L (each)
56897	Spike oval	Flame	R/L (each)
56898	Spike oval	Skull	R/L (each)
56899	Spike oval	Maltese	R/L (each)



Chrome Billet Mirrors

PCP	Mirror	Stem	Fits
56882	Oval	Flame	R/L (each)
56883	Oval	Maltese	R/L (each)
56884	Oval	Diamond	R/L (each)
56885	Diamond	Diamond	Set
56886	Diamond	Flame	Set
56887	Diamond		R/L (each)
56888	Oval	Smooth	Set
56889	Oval		Set

Mirrors

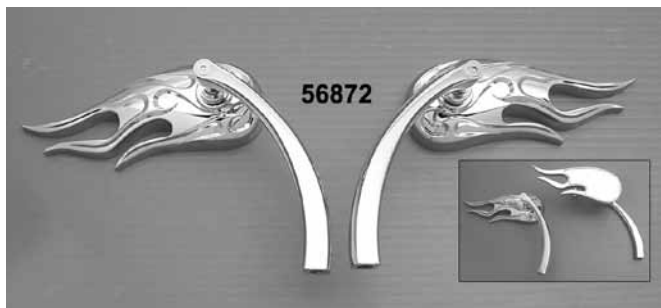

Fireball Mirror Set

Mirror sets come with both long and short plain stems or for a more custom look PCP# 56874 come with one size flamed stems.

PCP	Finish	Stems
56872	Chrome	2
56873	Gold inlay	2
56874	Chrome	1 Flame stem



Three Skull Mirrors

Chrome mirrors feature a three skull design with billet stems. Mirrors are sold in pairs to fit left and right.

PCP	Type
56877	Teardrop
56878	Spike
56879	Skull stem (each)



Chrome Billet Mirror Set

Features adjustable angle face. Sold in pairs.

PCP	Type
56870	Ball milled
56871	Smooth

Mirrors



Chrome Billet Eclipse Mirror Set with Stems
56979



Chrome Billet "S" Curve Mirror Set with Stems
56980

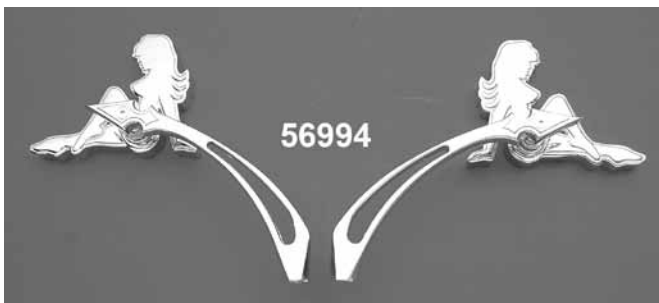
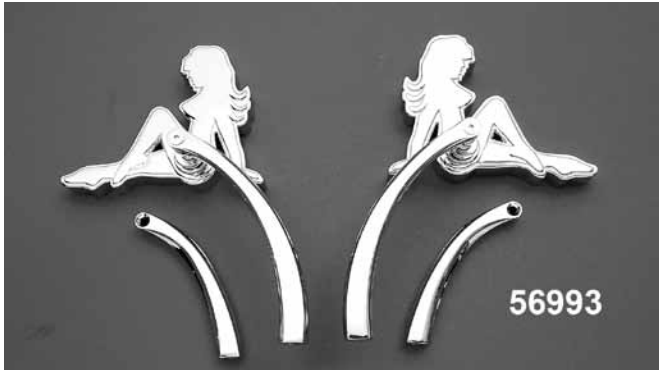

Lady Luck Mirror Set
Chrome mirror sets with billet stems.
56993 Long-short
56994 Spear



Chrome Tear Drop Mirror Set
Mirror set includes curved stems and mount hardware.
56942



5 Skull Billet Mirror
Right or left side complete with "worm" stem.
56866



Mirrors



Maltese Chrome Billet Mirrors

Sold each.

PCP	Stem
56990	Flame girder
56991	Girder
56992	Flame girder



Chrome Tear Drop Mirrors and Spacers

Mirrors feature retro styling with chrome and etched back. Sold as a set for right and left sides for 1982-on models. To use on pre1982 models spacer #16124 is required.

56925	Mirror set
16124	Stem spacers (pair)

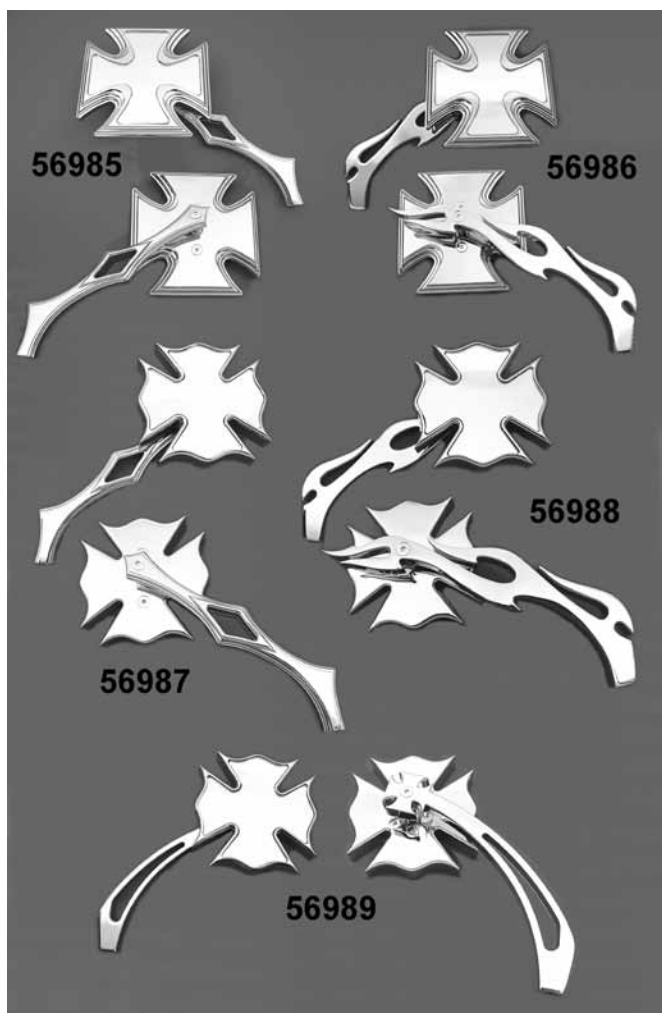

Maltese Cross Style Chrome Billet Mirrors

Sold each.

PCP	Stem
56985	Diamond
56986	Flame
56987	Diamond
56988	Flame
56989	Girder



Chrome Slim Profile Mirrors (Sold Each)

Chrome mirror fits left or right side and includes complete mount hardware and 2 stems, 5" and 3-3/4".

PCP	Style
56929	Smooth
56930	Axe
56931	Diamond
56940	Rectangular
56941	Oval
56942	Teardrop (pair)
56880	Crescent



Mirrors



3-D Style Chrome Mirror Set
 Each mirror features a 3-D design with solid stem.
56937 Set



Billet Style Cateye Mirror with Girder Stem
 Each chrome mirror measures 2-1/2" x 5" and has tinted glass.
56933 Each



Chrome Tear Drop Mirror Set
 Features radii stems, right and left.
56956



Mod Bevelled Oval Mirror Set with Girder Stem
 Each chrome mirror features a bevelled back and an abstract girder stem.
56935 Pair



Ellipse Chrome Mirror Set
 Each chrome mirror measures 5" x 2-3/4" with a 7" long stem and a built-in LED turn signal.
56936 Set



Eye Shaped Mirror Sets
 Mirror sets include stems.
PCP Stem Style
56847 With long and short
56848 Crane
56849 Twisted
56850 Spear

Mirrors



Chrome Bullet Mirrors

Chrome mirrors feature a fluid tear drop shape and curved stems to fit 1982-on control handles.

56954 Pair



Chrome Bullet Mirror Set

Chrome mirror features a slotted stem.

56939 91965-98



Flame Tear Drop Mirrors

Stylish tear drop mirrors feature popular flame design with a slotted stem. Available in chrome or gold inlay finish.

PCP Style

56951 Chrome

56952 Gold inlay



Chrome Round Skull Mirror

Chrome mirror features a raised skull and cross bones design and a chrome bone stem. Measures 3-9/16" in diameter.

56953 Pair



Chrome Oval Mirror

Chrome oval mirrors feature a contoured round stem. Fits left and right sides and includes hardware.

56938 Pair



4" Chrome Round Mirror

Large size for easy viewing.

56958 Stock type stem set

56959 Sliding stem (each)



Girder Mirrors

Chromed mirror with oval face and 5" mounting stems.

56901 Oval, 5x2½, Right

56902 Oval, 5x2½, Left

56906 Oval pair



Mirrors



Chrome Groove Back 2-5/8" Mirror Set
 Diecast chrome mirror features a 4-3/4" slotted stems.
56943 Set



Chrome Smooth Round Mirror Set
 Diecast chrome mirror features a curved stem. Pairs.
PCP **Size**
56945 3.5"
56869 2.75"



2" Chrome Cone Mirror
 Clamp-on chrome mirrors.
56946 Pair



64820



Styler Mirrors
 Girder stem design. Mirrors (and stem) are chrome plated. 5" mounting stems, sold in pairs.
56903 Eagle Spirit
56905 Smooth Back

Teardrop Die Cast Mirrors
 Chrome aluminum mirror with a classic design. Sold in pairs. Fit all models 1982-on.
64820 Classic (91971-98) USA
56925 Teardrop, imported (no logo)



Billet Oval Mirror Set
 Chrome mirror set features a 3 slot stem detail with convex glass that will match the late air cleaner cover.
56926 91513-99



Chrome One Piece Parallelogram Style Mirror
 Ultra modern mirrors feature one piece construction with a curved girder style stem and a raised pyramid design on mirror back.
56932 Pair

Mirrors



Chrome Eagle Spirit Mirror Set w/Girder Stems
56983



“Live To Ride” Mirrors

These beautifully detailed and plated die cast mirrors come in both Gold Eagle and Chrome “Live To Ride” versions. Handy one piece short stems for left & right sides. Eagle head faces left or right. Fits all 1965-on.

PCP Chrome
45100 Pair
45104 Left
45105 Right
56983 Pair with Girder stems



Taper Mirror Set with Billet Stems
56975

PCP Gold Eagle
45200 Pair



Chrome Convex Tinted Mirror Set with Billet Stems
56976



Chromed Stock Style Mirrors

PCP Fits
847 Tin mirror right or left side (4" x 5") (91869-83T)
848 As above, w/clamp (4" x 5")
891 Cast stock mirror right or left side (91875-70TB)



Rectangular Mirror Set with Billet Stems
56977



Chrome Billet Mirror Set with LED Signal
Features sequential LED turn signal on back side.
56867

Mirrors



Fairing Mounted Mirrors

These molded plastic mirrors mount inside the inner fairing on FLHT, FLHTC, FLHTCU 1996-on models.

64812 Set (91945-98)



Touring Mirror Set

Touring style mirrors are available with plain or with an optional LED turn signal set built-in.

PCP	Finish	Style
56857	Black	LED
56858	Chrome	LED
56859	Black	No lights
56860	Chrome	No lights



Chrome Mirror Set fits FLT (Fairing)

56868

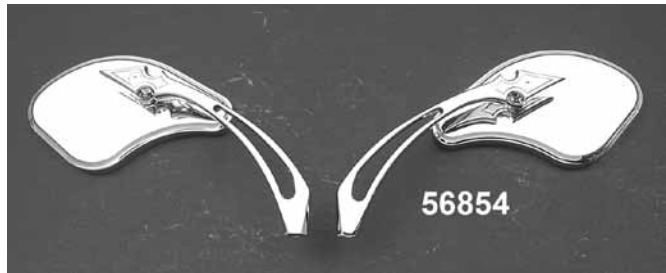
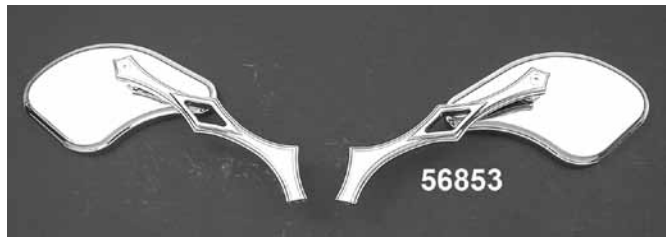
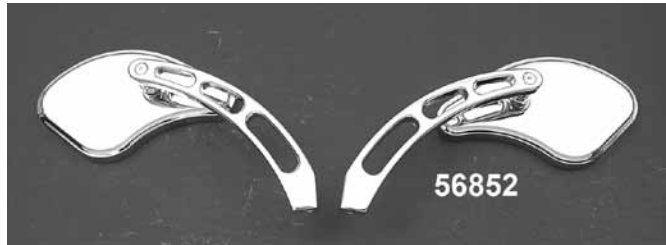

Pork Chop Chrome Mirror Set

Left and right set feature billet stems.

PCP	Stem
56851	Long or short
56852	Slot
56853	Twisted
56854	Spear
56855	3 Skulls
56856	Sickle

Mirrors



One Piece Die Cast Chrome Mirrors

Swivel head type for 1965-on, all models.

PCP	Type
6611	Short Right (91875-82)
6612	Short Left (91892-82)
6613	Long Right (91879-82)
6614	Long Left (91894-82)
891	Short left or right (91875-70)

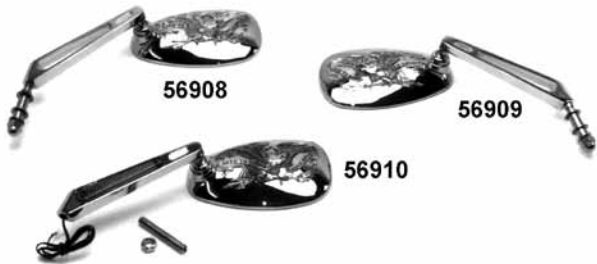

Teardrop "Live To Ride" Girder Mirrors

New teardrop design for "Live To Ride", chrome with gold inlay: all stems are 5".

56908	Chrome set
56909	Chrome set with gold inlay
56910	Chrome set with amber lights in stem

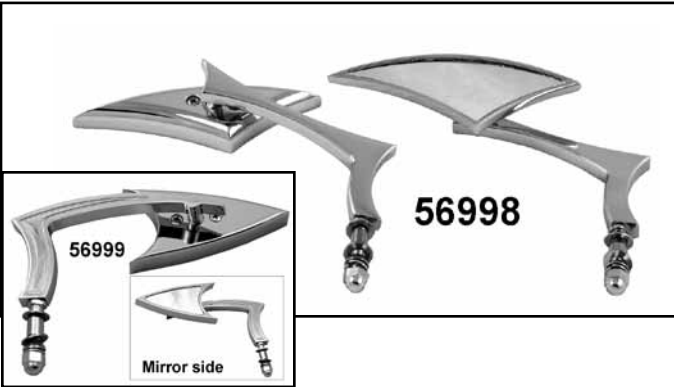

Odins Mirror with Billet Stem

Features offset billet stems and curved mirrors.

PCP	Style
56998	Billet (pair)
56999	Arrow (sold each)



Aluminum Billet Style Mirrors w/Logo

Aluminum mirror features run and plunge design, slotted stem and a diamond cut bar and shield logo. Sold in pairs. Fits all models 1982-on.

64815	Round (91529-99)
64816	Oval (91965-98)



Custom Round Mirrors

Custom 3" or 4" diameter round mirrors complete with 4" stems. These mirrors will fit the right or left side of all Harley models. Sold each

4753	3" mirror
4754	4" mirror
1456	3" clamp-on mirror with 10" stem
1457	4" clamp-on mirror with 4" Stem



T/L Dome Billet Style Mirrors

Mirrors feature a single slot stem. Sold in pairs for all models 1982-on.

64814	91519-99
-------	----------

Mirrors

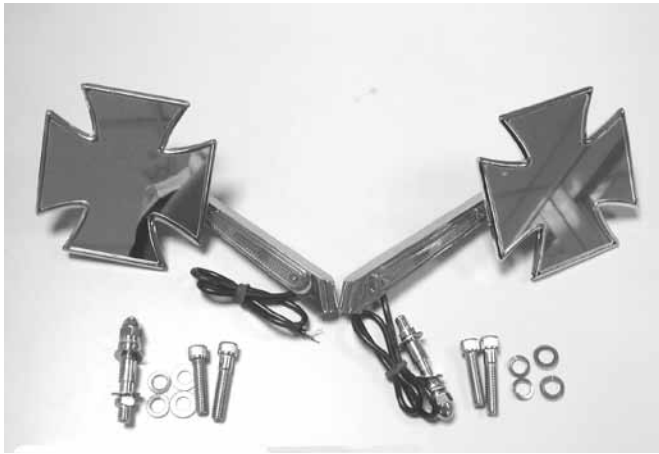

Chrome Maltese Mirror Set with Billet Stems and Lights
56972



Round Flame Mirrors

Are 4-3/4" O.D.

56961 Round with chrome finish (pair)

56967 Round with gold finish (each)

56968 Slot with chrome finish (each)



Chrome Maltese Cross Mirror Set with Billet Stems
56971



Chrome Snake Eye Mirror Set with Billet Stems
56965



Chrome Cateye Mirror Set with Built In Amber Turn Signals
56966

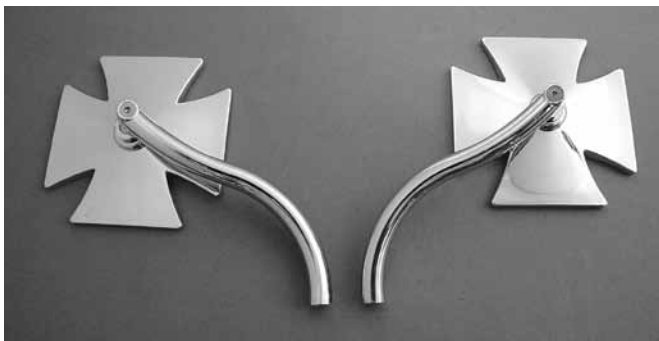

Chrome Maltese Mirror Set with Billet Stems.
56970



Chrome Billet Mirror Set

Stock style steel

56875

Mirrors



56947

Chrome Oval Mirror

FX-XL Type short diecast chrome mirror fits right and left sides 1965-on. Sold each.

PCP Style
56947 Smooth
56949 Stem with yoke



Oval Mirror with Billet Stem and Built In Amber Lamp
56978



Chrome Tear Drop Mirror

Fits left and right sides. Sold each.
56924



Chrome Stamped Rectangular Mirrors

These mirrors are offered as a sleek new look. Mirror surface is 4 1/4" wide x 2" high. These universal mirrors fit left or right side and are sold each.

56907



Maltese Cross Mirror

Features black wrinkle finish plastic construction with chrome steel stem and clamp.

56923



Oval Vision Deep Dish Mirror with Girder Stem

Each chrome mirror features a radius girder stem and can be used on right or left side.

56934 Each



56918

56919

Chrome Round Mirrors

Clamp on mirrors are available in long or short stem lengths with right or left side mount.

PCP	Description
56918	Short, right side (91930-92T)
56919	Short, left side (91931-92T)
56920	Long, right side (91932-92T)
56921	Long, left side (91933-92T)

Mirrors

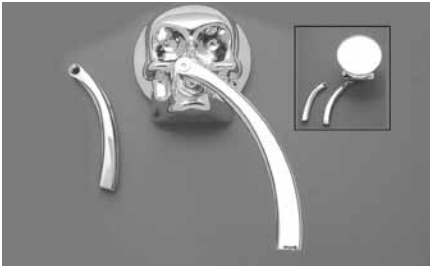

Skull Mirror

Includes 2 stems to fit right or left side.
56904



56912



56913

Flame Stem Mirror

PCP Style
56912 Smooth
56913 Diamond



Billet Chrome Fire Fighter Mirror

Includes both 3" and 5" arms. Sold each.
56984



Odins Mirror Set

Features offset diecast mirrors and stems.
56995



1988-on Convex Style Mirrors

56981 Right (91875-88)
56982 Left (91892-88)



Chrome Billet Replica Mirror Set

56997



Red Baron Billet Mirror (each)

Includes left and right billet stem.
56950



Die Cast Oval Mirror

Imported oval mirrors feature a "Billet" look with an excellent chrome finish.
56911 Sold each



Chrome Billet Cobra Mirror Set

56881



Chrome Mirror Stems

Come with a pair of acorn nuts.

27366 11"
27367 6-7/8"

Mirrors



Chrome Right Side Mirror Bracket 1996-on

The 1996-on style handlebar master cylinder has tight clearances that prevent the use of many custom mirrors. This adaptor moves the mirror up and out from the master cylinder.

27227



Chrome Billet Mirror

Fits right and left sides. Sold Each.

56876

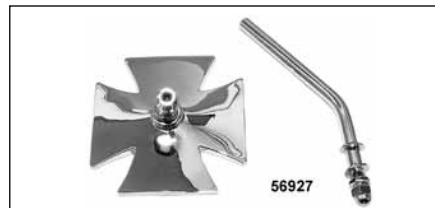

Chopper Chrome Maltese Cross Mirror

Diecast chrome mirrors are available in your choice of round or girder style stems. Sold each.

PCP	Style
56927	Round
56928	Girder



Chrome Rectangular Mirror

56955 Each



Deco Mirror Bracket

Chromed die cast bracket will attach any stock stud mount mirror to 1" handlebars when controls have been modified.

16212



Teardrop Mirror With Clamp-on Billet Stem

Sold each.

56973



Die-Cast Scroll V-Twin Type Mirror

Intricate scrollwork print highlights these die-cast mirrors. Fit into the stock clutch or brake housing for a direct replacement. Each features a fully adjustable housing and lightly tinted, 3-1/2" x 5" glass lens. Sold each.

4757



Micro Tear Drop Mirror with Slotted Stem

56957 Each



Chrome Mirror Extension Kits

These kits are used to extend mirrors approximately 2"

27129 Kit (91807-87)

Handlebars



FXSTS Ape Hangers

Feature 3/4" knurl spacing and indents for wiring.

PCP	Rise
51911	12"
51912	15"

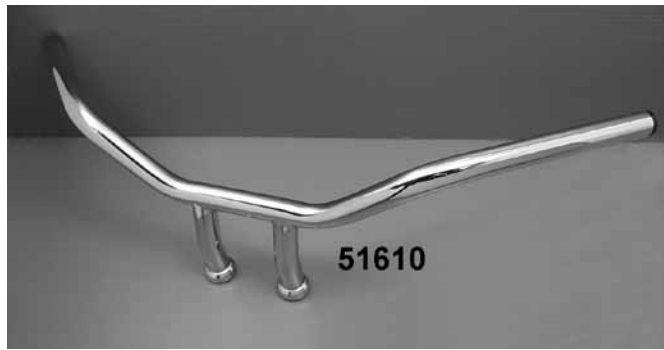

Chrome Riser Bars

Available with indents for 1982-on models or without indents. Risers measure 3-1/2" centre to centre and accept 1/2-20 threaded bolts.

1982-on	No Indents	Rise
51917	51610	5"
51918	51611	6"
	51612	8"
51919		9"



1-1/4" Buffalo Ape Hangers

PCP	Rise	Grips
51914	12"	36"
51859	13"	36"
51915	14"	36"
51916	16"	36"
51883	18"	37"



Swing Back Handlebar

Features 1" O.D. with indents.

PCP	Size
51920	6"
51921	8"



1.25" Tiller Bars

Features swept back design for extended neck fork applications. No indents.

51893



1-1/4" Buffalo FL Style Dresser Bar

Features stainless steel end risers, 14" pullback and 12" centre width with grips at 35" wide. Especially suited to tall riders.

51882

Handlebars



Speedster Style Bars

Chrome bars have a wide format to accept PCP #19847 cross bar, sold separately.

PCP	Application
51850	FX-XL
51851	FXSTS
19847	Cross bar



Dresser Style Bar 1 1/4"

Features 1-1/4" diameter with 34.5" width, 10" rise and 11" pullback with 1/2 x 20 threads.

51886



FLST 1-1/4" Beach Bars

Pre drilled for internal wiring shape provides comfort with control. Use with stock risers and clamps.

51902



33" Chrome Police Bar 1982-on

Chrome bar has knurls, indents and wiring clip holes.

51894

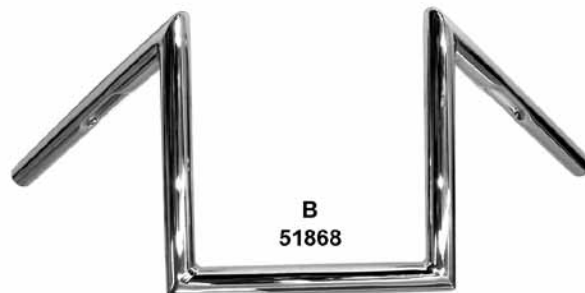
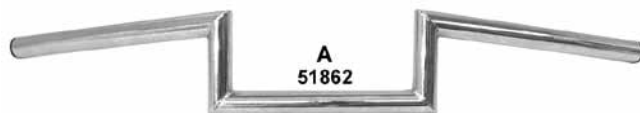

Chrome 1" Z Type Handlebars 1982-on

Bars feature early chopper styling without knurling. With indents. For 1982-on.

PCP	Height
51862	4" (A)
51864	6" (A) 28 O.A.Width
51865	6" (B) 25" O.A. Width
51868	10" (A)



1.5" Fatster T Bar 1982-on

Accepts GMA or other custom handlebar controls with switch housings for 1982-on. Has 3.5" bolt centres for 1/2 x 20 bolts.

PCP	Size
51852	6"
51853	8"
51854	10"



Chrome Radius Handlebars

Features drilled and dimpled 1" bar to hide wiring. Threaded 1/2 x 20 on 3-1/2" centres. 31" Wide with 8" pull back.

51870

Handlebars



1" Drag Bar

The perfect handlebar to be used with today's "Digger Style," "Low Rider Type," "Cafe," or "Road Racer" motorcycle. Sweep back angled styling, good heavy quality tubing and a bright show chrome finish make these bars extremely popular. Bars are available in 1" diameter with choice 15° or 30° bends.

6469 15°

51908 30°

6330 15° w/Indents 1982-on (28" wide)

51909 30° w/Indents 1982-on



Stock FXWG Pullbacks

Replaces OEM 55950-80. Good looking and comfortable, these regular pullback style handlebars feature smooth flowing bends, heavy wall steel tubing, and an outstanding chrome finish, a medium rise height, a good wide handle spread, and narrow mounting width, make these pullbacks one of the most popular handlebars of all time.

6335 FXWG Pullback



Low Ride Style Drag Bars

These bars offer the comfort of a regular pullback bar but still retain the drag bar look. Measures 8" across riser mount, 7-1/2" grip area and 31-3/4" across.

6105 2-1/2" rise

51872 2" rise bar with indent 1982-on



Chrome 'Hidden Wire' Handlebars for Heritage

These handlebars have the wiring harness clip holes already in them. The bends are designed like those found on early dressers and are specially designed to fit Heritage Softail® models 1986-on. These 1" bars will also fit all models from 1982-on with handlebar controls that require the wiring dimple. They measure 33-1/2" wide with a 12-1/2" centre width, a 6" rise and a 9" pullback.

51701

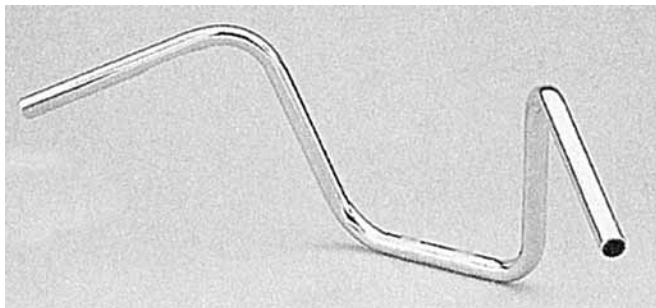

Mini Ape Hangar Handlebars

Deep, diamond knurls on 3 1/2" centres helps to prevent slippage or twisting common with high rise bars and two piece risers. 33 1/2" wide, 9" high

51704



Wide Drag Bar

Bars feature knurls at riser area and are available with or without indents.

PCP **Description**

51845 32" Smooth

51846 32" With indents

51847 36" Smooth

51848 36" With indents



Chrome Cross Bar

OEM type with clamps replacing 56575-26 for FL model handlebars.

51101

Handlebars



Police Style Bars

Wide style FLH Tour bars. Measures 12" across riser mount area. Excellent for Dog Bone or Flanders style risers. Keeps grips 31-1/2" apart and a 4" rise for full control.

6100 Pre 1982 (no indents)

51894 1982-on with indents



Chrome Beach Bars

These bars are 39" wide at the grip area with a 5" rise

51702 With indents



Bagger Bars

These 1-1/4" bars fit FLT models and feature a setback to accommodate fairing.

PCP	Height	Type
51931	13"	Round
51932	16"	Round

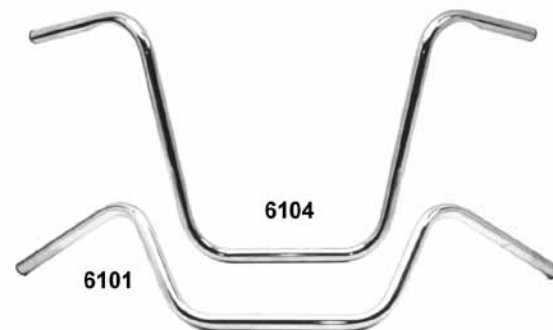

V Bars

1" O.D. bars with indents.

51871

Ape Hangers

Show chrome plated. Our 1" dia. ape hangers are 38" wide at the grips. Center 11". Available in 8", 10", 12" and 16" heights.

Pre 82	82-on	Rise
6101	51904	8"
6102	51905	10"
6103	51906	12"
	51877	14"
51874	51878	15"
51875	51879	16"
	6104	16"
51876	51880	18"

Handlebars



51869



51859



51844

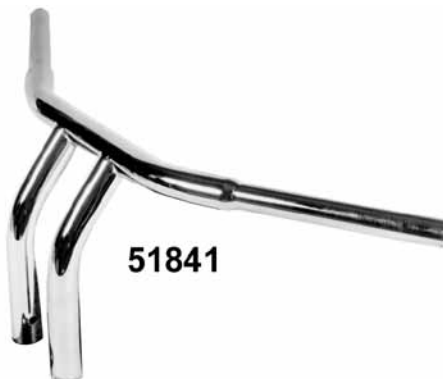

51841

Chrome Buffalo Bars

1-1/4" bars have indents to fit 1982-on FX, XL, FLH models.

PCP	Style	Width	Height	Pull Back
51856	T-Bar	32-3/4"	10"	11-1/2"
51841	T-Bar	32"	8"	11-1/2"
51859	Ape Hanger	35"	13"	10"
51844	Dresser	35"	3-1/2"	10-1/2"
51869	FXSTS 88-*	36"	1.5"	12-1/2"
51861	Drag 1.25" O.D.	30-1/2"		
51907	Drag 1.5" O.D.	30-1/2"		



51715



51610

Pullback "T" Drag Bars

Two types of our popular bolt-through style handlebars for the Low Rider look. Made on 3-1/2" bolt centers and mounts with 1/2" bolts. Fits stock, Sportster, and Superglide front ends as well as most custom front ends. Available in 1" O.D. tubing only, with 4" and 8" rise heights. Keeps grips 23" apart.

Dimpled handlebars to use with late model recessed cable controls: (1982-on style)

51715 8" Rise

Not dimpled handlebars to use with nonrecessed cable controls: (pre-1982 style)

6339 4" Rise

Custom Bars with Pullback Risers

These chrome 1"-diameter bars are made in the USA and are available in six sizes and styles to fit all Sportster® and Big Twin models. Both the early-style (pre-1982) and the late-style bars (dimpled for wiring) are available in three different heights. All bars are 28" wide with a 3-1/2" riser centre.

Early Style Pre-82

51610 5" Rise

51611 6" Rise

51612 8" Rise

Late-Style

6595 3" Rise

6596 5" Rise



1-1/4" Replica Bar

Full 1-1/4" OD bars will fit 2007 FXD, FLSTF models.
51928

Handlebars

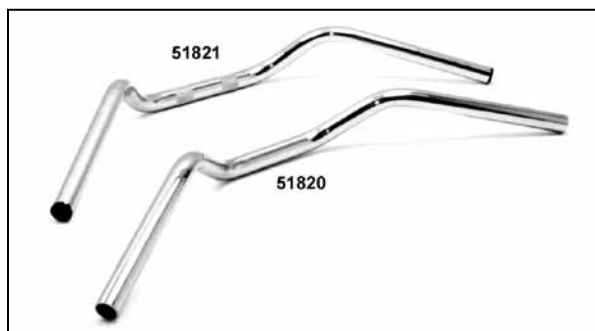

Chrome Stock Replacement Bars

PCP	OEM	Model	Width	Indent	Knurl	Rise
51820	56082-83	XL 883 Low	28"	Yes	No	2-1/2"
51821	56473-98	XL Sport	27 1/2"	Yes	Yes	3 1/2"
51827	56081-83	FXR	26	Yes	Yes	7
51828	56081-82	FXST	25 1/2"	Yes	Yes	6-1/2"
51829	56093-88	FXSTS	26 1/2"	Yes	Yes	7 1/2"
51830	56079-93	FXDWG	31 1/4"	Yes	Yes	10 1/4"
51831	56569-86	FLST	31	Yes	Yes	8 1/2"
51822	56557-95	FLSTF, FLHR	30 1/2"	Yes	Yes	7
51823	55919-82	FLSTF, FLHR	31 3/4"	Yes	Yes	6
51824	55933-97	FLSTS, FLHR	29 1/2"	Yes	Yes	6
51929	55908-04	FLHRS 04-*				
51700	55920-83A	FLT w/o air	31"	Yes	No	7 1/2"
51930	56184-08	FLT 2008-*				
51825	56086-81	FLH, FX	24 1/4"	No	Yes	7
51924	55950-80	FXWG		Yes	Yes	
51903	55963-77	FXS		No	Yes	
51925	56003-75	FXE		Yes	Yes	
51926	56003-76	FXE		No	Yes	

Width=inside to inside of widest grip area. Rise is from top of clamp area to top of high part of handlebars.

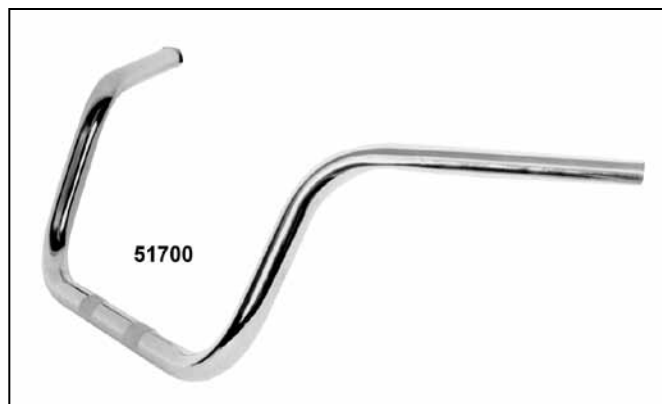
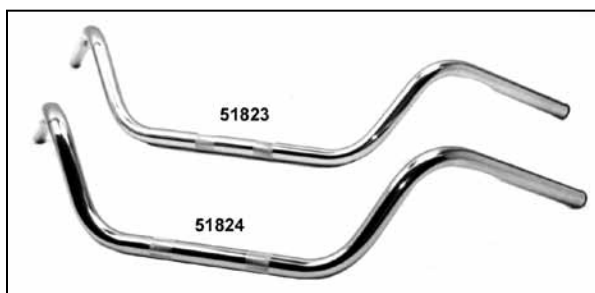

Handlebar Mount Kits



44017



44016



44015



44000

Chrome End Caps for Allen Bolts

Snaps over Allen head screws, to cover hole.

- 44000 3/8" plugs, 10 pack
- 44015 5/16" plugs, 10 pack
- 44016 1/4" plugs, 10 pack
- 44017 End plug assortment tray, 100 of each size



Chrome Flush Mount Top Triple Tree Bushing Kit

Kit includes 4 chrome steel bushings with o-rings for dampening and 1/2" x 13 thread chrome allen bolts.

59027



Chrome Billet Solid Mount Kit

Replaces stock rubber bushings and cap washers.

51024



Chrome Handlebar End Plugs

These are accessorized with jewels and skulls.

- 50000 Plain chrome (10 pk)
- 50002 w/Amber Jewel (pair)

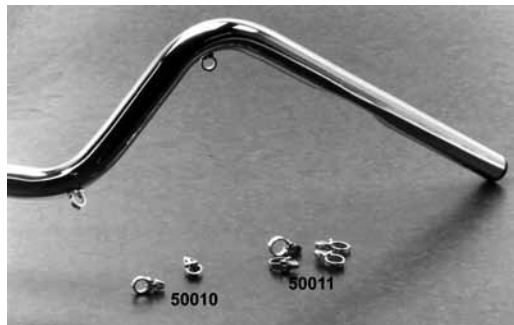

Handlebar Wiring Clips

Chrome, nylon clips are exact duplicates of the Original Equipment pieces installed on the handlebars of most late model bikes. They feature a specially-processed chrome-plating which is surprisingly durable and resists cracking.

PCP Fits (4 Pack)

- 50010 3/8" I.D. (56073-83)
- 50011 1/2" I.D. (70345-84)



Machined Chrome Washer Set

Extra heavy 4 piece set fits all stock rubber bushing sets.

51023

Handlebar Mount Kits



Chrome Riser Adaptor Kit

Allows the use of custom risers on the FXSTD Duece.
51021



Chrome Riser Sleeves

For use with riser drag bars.

PCP **Size**

51025 1"

51026 1.25"

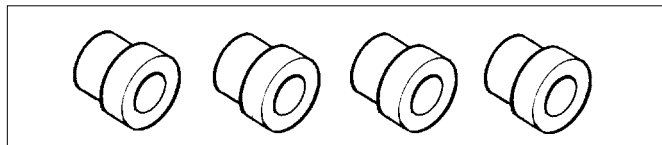

Handle Bar Bushings

American made bushings consist of vibration absorbent polyurethane for 25% stiffer construction than stock rubber units. Four piece set fits FX, FXST, FXR, XL 1973-on and Dyna models. Replaces OEM 53156-86 & 56158-86.

51003



Solid Handlebar Mount Kits for Harley

Designed to eliminate rubber-mounted handlebars. Will fit all top fork trees. Easy to install and highly recommended when installing high bars and/or risers.

4794 Sportster & FX

4795 74 FL's



Handlebar Damper Kit

A rubber handlebar mounting rebuilding kit complete with handlebar spacers, cup washers and rubber bushings for all Harley models 1973-84. Each kit mounts one set of handlebars. OEM 56153-73, 56158-73 and 56159-73.

1795 Kit with zinc washers FX-XL-FXST-WG

51002 As above chrome washers

Nylon Handlebar Damper Kit

Machined white nylon, provides a stiffer, dampening action, and longer life for all FX-XL 1973-84.

4822 Kit with zinc plated washers

Handlebar Riser Damper Kit

Includes all rubber bushings, threaded studs, washers and cups for 1984-on models.

4912 FXRT 1984-85

Sportster L 1984-94

FXSB-EF 1985

4913 FLSTC 1987-on

FXR, RC, S, SP 1987

4914 FLT 1984-on

4915 FXST-FXSTC 1986-on

1795 FXST-1984-85, FXWG 1985

NOTE: Studs not applicable on kits
4915, 1795

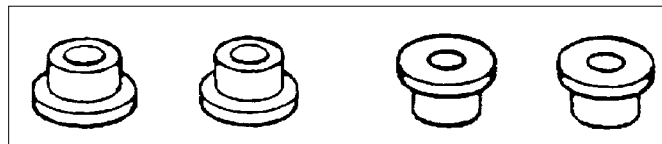
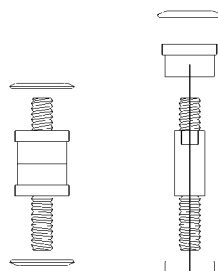

Handlebar Damper Bushings

Sold in sets of 4 to replace OEM rubber type.

PCP **Application**

51007 FXST, Dyna 1986-on (53156-86)

51008 FXE, FLT 1948-85, FXR 1982-94 (56158-73)

51009 FLT 1984-on (56161-83A)



Handlebar Riser Washer Kit

Chrome plated, cupped washers for handlebar risers. Fits all models 1973-on and replaces 56159-73. 4 Pack.

72123

Handlebar Mount Kits



Handlebar Bushing Kit

Made of red polyurethane for stiffer construction than stock rubber units and are vibration absorbent. Four piece set replaces 53156-86 and 56158-73 on FX-FXST-FXR-XL and Dyna models

51011 Kit with chrome washers



Chrome Riser Bolt Sets

Each chrome polished set includes 2 bolts and 2 lockwashers.

Allen	Hex	Size
72094	72135	1/2-13 x 2-1/2
72095	72136	1/2-13 x 2-3/4
72129	72137	1/2-13 x 3
72130	72138	1/2-13 - 3-1/2
72131	72139	1/2-13 x 3-3/4
72132		1/2-20 x 2-1/2
72133		1/2-20 x 2-3/4
72134		1/2-20 x 3



Heavy Duty Polyurethane H/bar Dampener Kit

Dampeners reduce vibration while providing resistance for improved handling. Kit includes chrome washers to fit most models 1973-on.

51004 Kit with steel bushings

51010 Kit with brass bushings



Chrome Riser Bolt Kit

These bolts feature integral lower flange, washer and a flush allen head. Kit includes spacers and chrome top washers.

24097 1/2 x 13

24098 1/2 x 20

Riser Stud Conversion FXSTS 1988-on

Use so that FXSTS studs will accept 1/2x20 threaded risers.

21514



Chrome Flush Mount Handlebar Damper Kits

Damper kits feature a machined washer design.

PCP	Size
51019	1/2 x 13
51020	1/2 x 20



Chrome Billet Cone Head Riser Mount Kits

Include poly bushings with washers, cones and bolts. 3-1/2" Long.

PCP	Bolts
73681	1/2 x 20
73682	1/2 x 13

Handlebar Riser Clamps

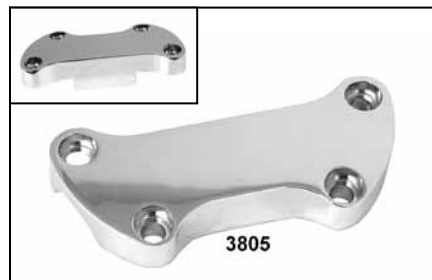

Chrome Handlebar Riser Top Clamps for 1974-on FX, FXR, FLH, FXST, FXWG, XL Models

Will not fit XL Custom or Deuce models.

With Front Panel Skirt

PCP	Style
3805	Smooth
51319	Finned
51321	Antique

Without Skirt

PCP	Style
1377	Smooth
3814	Finned
51300	Scalloped
51301	Eagle Spirit
51302	Live to Ride
51304	Smooth w/hidden bolts
45214	Eagle Spirit w/gold inlay



Fat Handlebar Clamp Set

Fits over existing risers on 2000-on FLSTF and 1999-on FXDWG.

- 51359 Top clamp set (fits over stock cap)
- 51361 Riser stems



Chrome Billet Style Riser Cap Set

Curved 2 piece cap set replaces 56057-00 to fit riser which accepts the one piece clamp.

51339

Note: All riser measurements are from the bottom of post to the bottom of the handlebar hole

1 1/4" Handlebar Risers

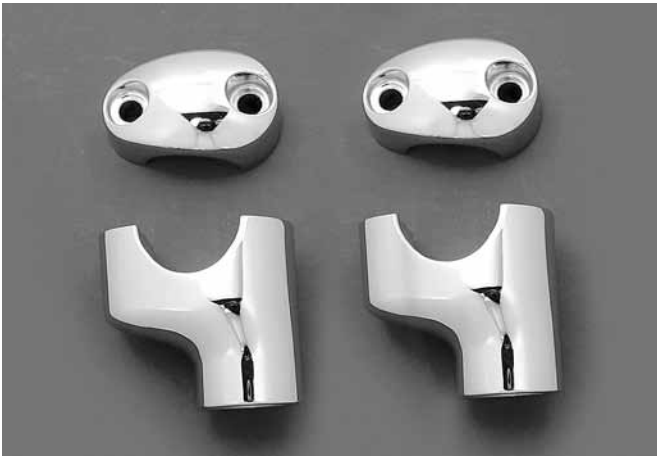

Chrome Riser Set FXDWG 2006-on

Fits 1-1/4" bars on 2006-on FXDWG. Has 1-1/4" riser hole diameter.

51337



Shorty FXDWG 1.25" Riser Set

Fits 1-1/4" bars on 2006-on FXDWG.

51340



Chrome Solid Billet Riser Sets

Features 1/2 x 13 mount threads and a 1-1/4" I.D.

PCP **Height**

51376 3"

51377 4"

51378 5"

51379 6"

51380 8"

FXDF Chrome Riser Set

Features 1-1/4" I.D handlebars on 2008-on FXDF.

51395



Chrome Riser Set FLSTF 2007-on

Fits 1-1/4" bars on 2007-on FLSTF models.

51352



Chrome Riser Set

Fits 1-1/4" bars on 2006-on FXST.

51329



Chrome FXSTC Riser Set

Fits 1-1/4" bars on 2006-on FXSTC.

51323

FXD Chrome Pull Back Riser Set

51396



Handlebar Risers



Chrome Solid Billet Riser Sets

Feature 1/2 x 13 mount threads.

PCP	Size
51350	3"
51351	4"
51369	6"
51370	8"



Stock Type Risers

Chromed steel risers feature original tapered type, through bolt design. Bolts sold separately.

PCP	Rise
51354	3"
51355	3" threaded
51356	5"
51357*	5"
51358*	3"

*Note: Feature rubber ISO inserts and 5/16" allen screws



Forged Riser Sets with Hidden Top Screws

PCP	Height
51371	2"
51372	4"
51373	6"
51374	8"
51375	10"



8" Post Riser

Features hidden top screw cap system. Tapped 1/2" x 13 thread.

PCP	Design
59290	Plain
59291	Maltese



Chrome Glide Risers

Chromed steel risers have 1/2 x 20 threads.

PCP	Height
51360	4"
51362	6"

Handlebar Risers



Chrome Stock Riser Set

Complete set includes finned riser cap and screws. Use 1/2" x 13 mounting bolt. Stock on all 1977-on models.

PCP	Description
51332	1-1/2" kit
51333	1-1/8" kit
51334	FLST kit (includes bolts)



FXS Pullback Risers

1-1/2" set back. 4" rise so handlebars will clear Fat Bob tanks. For any Sportster or Superglide designed to accept stock upper handlebar clamp or our custom clamps. Sold as a set. Uses 1/2 x 13 mounting bolts.

5769 With plain cap



Straight Riser Kit-FXWG Style

Replaces OEM 56142-80. Stock on all 1980-on FXWG's. 3-3/4" straight riser set comes complete with chrome riser cap and screws. Use 1/2" x 13 mounting bolts.

5770	Plain cap
51343	Scalloped cap

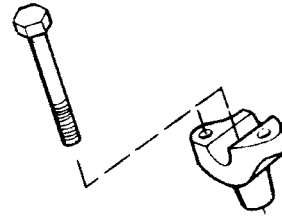

Sold in pairs.

Handlebar Riser Bolts

Exact replacement for the OEM type riser bolts.

PCP	Length	Application
5020	1/2 x 13 x 3-1/4	1983-on all XL (3431)
5021	1/2 x 13 x 2-3/4	1984 FL's, 1984-on FXWG (3507)
5023	1/2 x 13 x 2-1/2	Custom



Handlebar Top Clamp Chrome Bolt

PCP	Type	Year	Model
5386	Allen	L77-84	FL
5387	Allen	1982-on	FX-XL
5312	Cap	1974-on	FX-XL
5313	Acorn	1983-94	XL-FX w/handlebar mount gauges
9636	Allen	1983-94	XL-FX w/handlebar mount gauges
9961	Acorn	1995-on	XL w/handlebar mount gauges
9962	Allen	1995-on	XL, FX w/handlebar mount gauges
9778	Acorn	1996-on	XL, BT



1-1/2" Straight Risers for FX-FXR-XL 1984-on

These risers are chromed and threaded for 1/2-13 mounting bolts or studs. Replaces 56116-82 & 56117-82 (not FXWG) 51314

Note: All riser measurements are from the bottom of post to the bottom of the handlebar hole

Handlebar Risers



Eagle Riser and Clamp Kits

Eagle Spirit chrome risers are available in straight or pullback styles. Fits BT and XL 1973-99 with 3-1/2" spacing and 1/2"-13 threads.

51336 Straight 3-3/4"



Chrome Ribbed Pullback Riser Kit

51353 3-1/2" c/c (4" rise)



1-1/2" Chrome FLST Stock Riser Stems

51313 56541-86A and 56542-86A



Shorty Riser Set

Features 1" rise with 1/2" x 20 threads.

51344



Dawgbones Offset Risers

Dawgbones complement the style of the Springer Softail and take you back to the look of the 1940's. They're finished with a deep chrome plating. Vibration dampened with rubber grommets for a softer ride. Fits 1" bars.

PCP **Size**

51322 (A) 6" 1988-06 FXST Springer

51312 (B) 2"

51324 (B) 4"

51325 (B) 6"

51393 (B) 8"

23065 Rubbers for above (set)



Chrome Paughco Post Risers

Machined steel risers have 1/2x20 internal for mounting.

PCP **Rise**

51341 3"

51342 5"



5-1/2" Chrome Straight Riser Kit

Risers measure 5-1/2" tall and replaces OEM 56223-98 on FX, XL and FXR models 1977-on. The use of longer cable, wiring or brake hose may be necessary.

51330 Rib style

51335 Smooth style

Note: All riser measurements are from the bottom of post to the bottom of the handlebar hole

Handlebar Risers



Billet Tilt Back Risers

PCP	Height
51365	3"
51366	4"
51367	6"



Chrome 5" Pull Back Riser Set

Solid mount risers with 1/2" x 13 mount holes.
59028



Chrome Curved Riser Sets

Pullback riser kit includes 2 piece cap set, risers with 5" rise, 2" pullback and 1/2" x 13 internal threads.

51338 "Fatty" style (56033-00)
51364 Slotted style



Chrome Forged Aluminum Pull Back Risers

Are available as stems only that can be used with stock top clamp or #51339 billet cap clamp. These risers are also available as a set which includes top clamp. Posts have a 1.1" diameter and use 1/2"-13 mounting bolts.

Stems Only (no clamp)

PCP	Height
51387	4.5"
51388	5.5"
51389	6.5"

Riser Set Complete with Clamps

PCP	Height
51390	4"
51391	5"
51392	6"



Allen Bolt Custom Cap Covers

These cap covers are sized by bolt thread diameter. Chrome plated and machined from aluminum, these caps come with set screws and an allen wrench. **Sold in pairs.**

45310	1/4"
45311	5/16"
45312	3/8"

Handlebar Risers



Custom 1" Risers (Pair)

These die cast risers feature a brilliant chrome finish and will mount to all top trees with 1/2"-13 mounting bolts (not supplied).

- 838** 4-1/2" Plain
- 842** 2-1/2" Plain
- 2451** 2-1/2" Fancy Pullback



Round Risers (Pair)

- 51309** 4-1/2" diecast



Chrome Die-cast Stock Style Risers

- | PCP | Fits |
|--------------|---|
| 840 | 3-3/4" FXWG style (56098-80, 56099-80) |
| 3551 | 1-1/2" Stock Risers. FX-XL 1974-on (56116-77, 56117-77) |
| 51310 | 1-1/8" short risers for FL L1977-84 fit under handle bar clamp (59940-79, 59941-79) |



2254

Chrome Die-cast Stock Style Risers

Drilled and tapped for 1/2"-13 mounting holes. Fits 1974-08 FX and XL, 1977-82 FXS, 1982-94 FXR/S/T, 1980-86 FXWG, 1984-08 FXST and 1993-08 FXDWG.

- | PCP | Style |
|-------------|----------------------------------|
| 2254 | 4" Pullback (56122-77, 56124-77) |

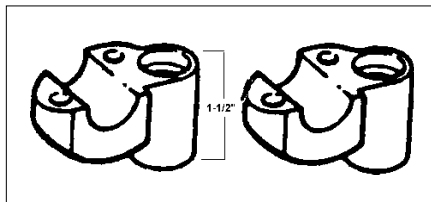

Offset Risers

Chrome 1986-on FXR riser replace 56144-86 right and 56146-86 left. Places bars 1" closer to rider and can be adapted to earlier models.

- 4836** 1" Rise (pair)



FLH Style Chrome Stock Riser Stem

1-1/8" High riser stems are sold in pairs.

- 51317**

Note: All riser measurements are from the bottom of post to the bottom of the handlebar hole

Handlebar Risers



Chrome Pull Back Riser Set

Features 1/2" x 13 threads for mounting.

PCP **Height**

59201 9.5"

59287 7"

72131 Mounting bolts



9-1/2" Chrome Buffalo Riser Kit

Includes scalloped 9-1/2" chrome risers, top clamp and SS allen screws. Accepts 1/2 x 13 bolts.

59289

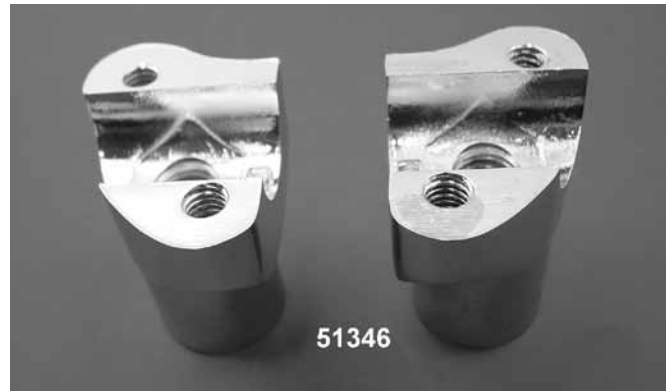

Chrome Buffalo Riser Sets

Accepts stock top clamps or PCP# 51339 billet caps.

Straight **Height**

51345 1.7"

51346 2"

51347 4.5"

51348 5.5"

51349 6"



Vintage Top Clamp & Custom Riser Kits

These kits include riser, top clamp & hardware.

51318 2-1/2" riser & top clamp



Chrome Buffalo 9.5" Riser Set

Features billet top caps. Accepts 1/2" x 13 mount bolts.

59288

Handlebar Risers

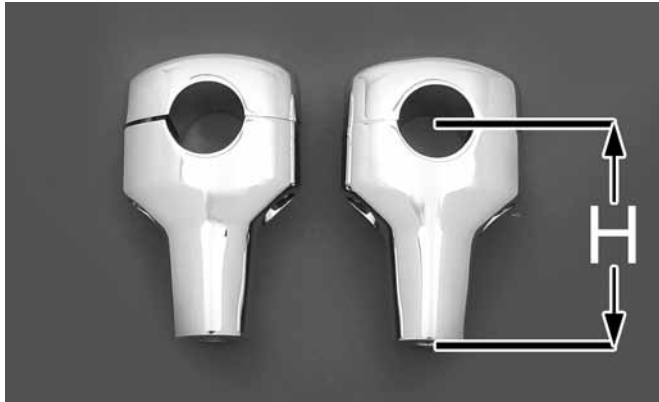

Chrome Short Riser Sets

Fits 1" bars.

PCP **Height**

51315 2"

51316 1 1/2"



FXD Chrome Pull Back Riser Sets

51368



4.5" Chrome Riser Sets

Includes top clamp and screws.

51386



Touring Chrome Riser Set 1988-on

51363



Wyatt Riser Sets

1/2" x 13 thread.

PCP **Height**

51381 2"

51382 4"

51383 6"

51384 8"

51385 10"

Handlebar Controls

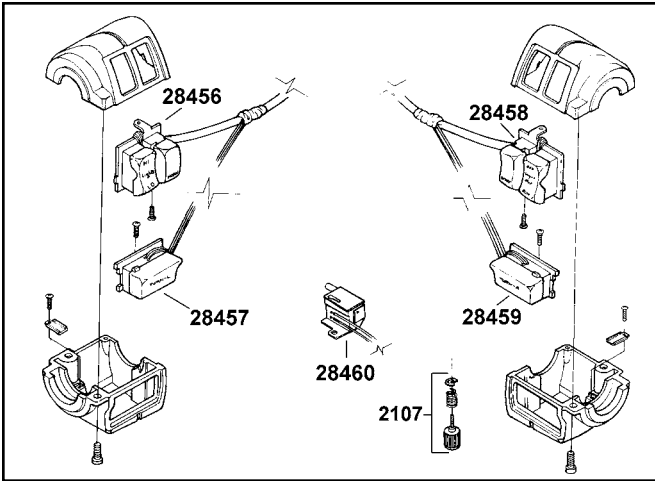

1982-95 Handlebar Switch Assemblies, Black

PCP	Item
28457	Left turn signal (71598-92)
28458	Engine, stop/start (71589-92)
28459	Right turn signal (71591-92)
28456	Dimmer & horn (71597-92)
28460	Stop switch, front (71590-92)
28469	Stop switch 1972-81 (72001-69B)
28450	Switch Kit, one each of above switches black (set)
28451	As above, chrome set
2107	Throttle adjusting screw all models 1974-on with stock throttle (56397-74A, 56394-74)



Clutch Lever Assembly 1982-95

PCP	Description
46006	Chrome assembly (with anti-rattle device)
50211	Black assembly
50205	Black clamp and bracket (38608-82A)
50206	Chrome, as above
46007	Black clamp only (45044-82)
46005	Chrome clamp only



1982-95 Chrome Handlebar Controls

Chrome handlebar mounted brake & clutch control assemblies with switch housing (use your OEM wiring parts). The clutch lever assembly includes both style of cable pin which will permit the use of the early style cable, as well as the latest eyelet type.

PCP	Fits
90111	With 5/8" (.625") bore master cylinder for all single disc models 1984-95
90112	With 11/16" (.687") bore master cylinder for all dual disc models (except those with radio controls) 1984-95
46702	5/8" Master cylinder for all models 1982-95 (45013-82, 45019-85)
46001	Switch housing, right top (71564-82)
46002	Switch housing, right bottom (71563-82A)
46003	Switch housing, left top (71567-82)
46004	Switch housing, left bottom (71568-82A)
46005	Replacement lever clamp only, for clutch & brake (45044-82)
10165	Replacement nylon pin for eyelet style cables (45036-88) (5 pack)



1982-06 Switch Housings (Not for Radio)

A 4-piece chrome set replacing upper & lower of right & left sides. Use your existing screws and wiring/switches for assembly.

46010	Kit (Set of 4) 1982-95 (not for radio)
46011	Kit (set of 4) 1996-06 (not for radio or FXSTDSE or FLHRSE1)
24503	Cad screws 1982-95, (OEM 2508) (10 pack)

Handlebar Controls



Complete Harnesses with Switches 1982-95

Each switch set comes with a 48" wiring harness which will accommodate tall handlebars. They are ready to install in **your switch housings**. Fits all Sportster® and Big Twin models (except those with radio controls) 1982-95.

- 28450** Complete Kit, Black
- 28451** Complete Kit, Chrome

Replacement Switches

Suited as replacements to the original parts. Comes soldered to 12" lengths of wire. Fits all Sportster® and Big Twin models 1982-95.

Black	Chrome	Description
28456	28461	Dimmer/Horn (71597-92)
28457	28462	Left Turn Signal (71598-92)
28458	28463	Engine Start/Stop (71589-92)
28459	28464	Right Turn Signal (71591-92)
28460		Front stop switch (71590-92)



Chrome Banjo Bolts and Washers

Replacement banjo bolts for OEM & PCP #46700 handlebar master cylinders on 1982-on models.

- 24030** Fits master cylinders with 10mm brake lines
 - 24031*** Fits PC Master Cylinder 46700 **only** when 12mm brake lines are used on 10mm cylinder
 - 24029** Fits master cylinders with 12mm banjo fitting
- *NOTE: Allows use of 12mm lines on a master cylinder with 10mm thread



Topline Turn Signal Switch 2000-on

- 29141** Left (71685-06)
- 29142** Right (71683-06A)



Chrome Billet Handlebar Control Kit

Kit includes a 5/8" bore master cylinder for 1982-95 models. This kit can also be used on 1996-on models with the purchase of 1982-95 style switches and some modifications.

- 59240** Kit
- 46115** Master cylinder rebuild kit



Polished/Chrome Allen Bolts

- 8767** Switch box kit 1982-95



Switch Box Allen Screw Kit

Handlebar Lever mounts + master cylinder cover screws. XL-FX-FXR-FL.

- 5359** 1982-95
- 9776** 1996-on XL, BT Button head
- 9778** Acorn as above



1996-on Switch Housing Kits

Kits include left and right upper and lower housings only. Switches and wiring not included. Not for use with radio.

- 46011** XL-FXST-FXDG-FLHR
- 45320** FLHT 1996-06
- 46047** BT 2007-on

Handlebar Controls

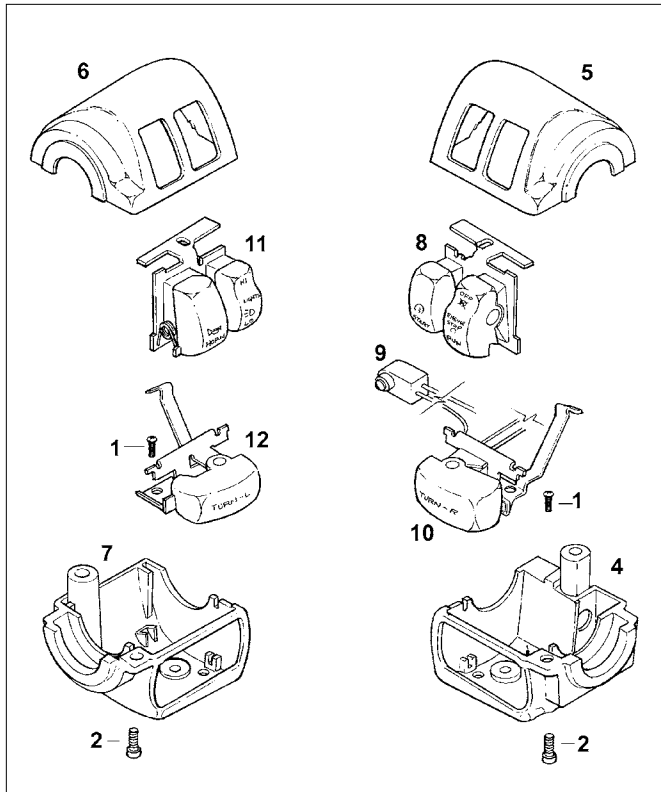

Black Switches & Housings for 1996-on

These black switches with white lettering are a direct replacement for OEM housings and each switch includes a cable strap and heat shrink tube, as stock.

#	PCP	Description
1	24549	Screw (2558) (10 pk)
2	24550	Screw (3658) (10 pk)
4	46008	Chrome lower right housing (71563-96)
5	46009	Chrome upper right housing (71564-96)
6	46012	Chrome upper left housing (71567-96)
7	46013	Chrome lower left housing (71568-96)
8	28487	Engine stop/start switch (71589-96A)
	28492	As above, chrome
	66149	T/L black engine stop/start switch (71684-06)
9	28488	Stop lamp switch (71590-96)
10	28489	Right turn signal switch 1996-06 (71591-96)
	28494	As above, chrome
11	28490	Dimmer and horn switch (71597-96A)
	28495	As above, chrome
	66151	T/L black dimmer and horn switch (71682-06)
12	28491	Left turn signal switch 1996-06 (71598-96)
	28496	As above, chrome
	29141	T/L left turn signal 2000-on (71685-06)
	29142	T/L right turn signal 2000-on (71591-00)
13	10430	(not shown) 6 way socket lock (72156-94) (10)
	10418	(not shown) terminal socket (72191-94) (10pk)

Switch Kits 1996-on

These switch kits are offered in black or chrome plated and include colour coded wires and switches attached. For 1996-on except radio control models. (housings not included)

PCP	Years	Wires	Description
28497	1996-06	48"	Black with white letters
28498	1996-06	48"	Chrome with black letters
28444	1996-06	106"	Chrome
59866	1996-06	60"	Chrome
28445	2007-on		Chrome XL, FXD
28446	2007-on		Black XL, FXD



Chrome H/bar Control Kit BT 1996-06, XL 96-03

Includes complete chrome master cylinder, clutch handle with clamp, and 2 pairs of chrome switch housings. Master cylinder has a clamp with both a 10mm and 12mm bolt. Will not fit BT models with radio or 2004 XL or models with hydraulic clutch.

- 90131 Kit 9/16" bore, SD
- 90132 Kit 11/16" with controls



46015

Chrome Clutch Handle Assembly 1996-on

Includes mount bracket, clamp and handle.

PCP	Application
46015	1996-03 XL and 1996-06 BT
46019	2007-on BT
46031	2008-on Touring FLT
59774	2004-06 XL
46033	2007-on XL



Clutch Lever Bracket 1996-09

Includes both halves. Does not work with 2008-09 Dressers or 2004-on XL.

PCP	Description
46016	Chrome (38608-96, 45044-96)
46017	As above, black
46018	Chrome clamp only (45044-96)



28497

28498

Handlebar Controls



Chopped Handlebar Master Cylinder & Control Housing Set BT 1996-06 and XL 1996-03

Does not fit models with radio.

PCP	Bore
90176	9/16"
90177	11/16"
90178	5/8"



Handlebar Control Kit BT 1996-06 and XL 96-03

Includes switch housings. Kits fit 1996-on with 1", 1-1/4" or 1-1/2" handlebars. Does not fit models with radio.

Does not include switches.

PCP	Years	Type	Size
90250	1996-06	SD	9/16"
90251	1996-06	Dual	11/16"
90252	1996-04	FLT	9/16" Dual
90253	1996-04	FLHT	11/16" Dual



T/L Chrome Switch Cover Set 1996-on

Snap on chrome covers replace existing black switch covers.

PCP	Application
62215	FX, FXD; XL, FLHR 1996-on, FLHRC 1998-01 and VRSC 2002-on (71804-03) w/no cruise control
62216	FLHT/ C, FLHX, FLTRX, FLHXXX 96-on (71803-03)
62217	FLHTCU 96-on, FLTR 98-on (71802-03)
62218	FLHRC/I and FLHR models with cruise control 2002-on (71808-03)
62223	FLHT/C/X, FLTRX, FLHXXX 96-* with cruise control (71816-09)



Chrome Smooth Contour Control Kit BT 96-06

Features a hidden underside mounting on the switch housings for an unobstructed smooth, rounded surface on the top housing. Switch housings use stock or chrome rounded switches (introduced on 1996 models). Available in complete kits with or without chrome switches. Complete kits include clutch and brake levers, master cylinder, switch housings, brackets and hardware. **Does not fit models with radio or XL 2004-on.**

No Switches	w/Switches	Application	Disc
90181	90184	(.562) 9/16" MC	Single
90182	90185	(.687) 11/16" MC	Dual
90183	90186	5/8"	Single



Chrome Handlebar Control Kit (Not w/radio)

Includes complete chrome master cylinder, clutch handle with clamp, stainless hardware and 2 pairs of chrome switch housings. Available with or without chrome switches.

With	Without	Years	Bore	Disc
90254	90131	1996-06 BT 1996-03 XL	9/16"	Single
-	90153	2007-on FXST, FXD	9/16"	Single
90255	90132	1996-06 BT 1996-03 XL	11/16"	Dual
90209	90127	2004-06 XL	1/2"	Single
90272	90273	2004-06 XL	11/16"	Dual
	90128	2007-on XL	1/2"	Single



XL Handlebar Switch Set 2004-on

62219 Replaces 70085-04

Handlebar Controls

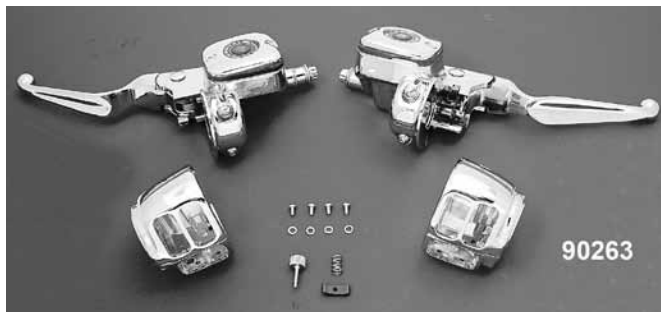

Chrome Smooth Contour Kit BT 1996-06

Features a hidden underside mounting on the switch housings for an unobstructed smooth, rounded surface on the top housing. Switch housings use stock or chrome rounded switches (introduced on 1996 models). Complete kits include clutch and brake levers, master cylinder, switch housings, brackets and hardware. Master cylinder is a single disc, hydraulic type with an 9/16" bore. Clutch handle is 11/16" bore.

PCP Style
90263 Contour



FLHT Chrome Switch Housing Kit 1996-06

45320

Custom Control Kit

Updated design utilizes 1996-on switches and features 9/16" master cylinder.

90297 Cable

Chrome Switch Housing and Switch Assembly

Assemblies include chrome housings, chrome switches, 48" long leader wires and internal mount screws.

PCP	Years	Length
59249	1982-95	48"
59250	1996-06	48"
59866	1996-06	60"



Chrome Switch Housing Set

Includes press-on switch cap set.

59878	1996-on FX, XL, FXD, FLHR, 1998-01 FLHRC/I
59974	1996-on FLHT/C/I, FLHX
59975	1996-on FLHTCUI and 1998-on FLTRI
59976	2002-on FLHRC/I, FLHR with cruise control

Handlebar Levers



1982-95 Clutch & Brake Lever

Sets feature Girder design with Girder skull ends, chrome.
50201



1982-95 Clutch & Brake Lever

Sets feature Girder design.
50200



Winged Brake and Clutch Levers 1982-95

These attractive levers are die cast and chrome plated.
50209 All models (pair)



Soft Touch Hand Levers, Brake & Clutch Sets

Available for all Harleys 1982-95. With a super comfortable soft rubber insert (over 3/8" thick) locked into a tongue-and-groove channel cast directly into the fully chromed 'power grip' hand lever.

PCP	Description
4761	1982-95



Pivot Pins and Lever Bushings

PCP	Application
10164	Hand lever anchor pin all 1982-87 (45036-82).
10165	Nylon clutch cable pin all models 1988-on, and for 1986-87 Sportster® or 1987 BT when converting to eyelet-style cables (45036-88) (5 pack).
13411	Lever bushing (45423-92) (10)



Chrome Lever Pivot Pins

Allen style for pivot point on 1982-95 models. Replacement for stock clutch and brake pins. Use stock retaining ring.
10200 45032-82 (pair)

Late Hand Lever Pin

Replacement hand lever pin for all 1982-on Twins. Replaces OEM 45032-82. Used on both brake and clutch control levers.

10159 Sold Each



Retaining Ring

For hand lever pivot pin. Replaces 11036 on FX-XL 1965-on. 10 pack.
11018



Switch Box Allen Screw Kit

Handlebar Lever mounts + master cylinder cover screws. XL-FX-FXR-FL.

5359	1982-95
9776	1996-on XL, BT Button head
9778	Acorn as above

Handlebar Levers



1993-95 Style Comfort Levers

The low profile plated OEM style replacements, will retrofit 1982-95. Chrome plated

PCP	Item
50202	Clutch 1993-95 (45047-93)
50204	Pair 1993-95 (45049-92)



Chrome Contour Levers

PCP	Year
50222	1996-06 Drilled
50223	1996-06 Slot
50230	1996-06 Button
50225	2004-on XL
50231	2007-on XL
50232	2007-on XL (holes)
50233	2008-on Touring
50234	2008-on FXD, FXST
50235	2008-on FXD, FXST

Contour Levers

1993-95 Style levers are sold in sets.

PCP	Application
50204	1982-95 chrome
50214	1982-95 polished
50215	1996-06 chrome
50219	1996-06 polished
50216	1996-06 chrome with skull
50224	2007-on chrome w/skull



Lever Blades 1982-95

PCP	Finish
2438	Polished (45016-82)
2440	Chrome (45064-82)

PCP	Finish
2439	Polished (45017-82)
2441	Chrome (45062-82)



Topline Polished Clutch Lever

29425	BT 1993-06 (45015-96)
50217	Preston as above



Brake Lever 1996-06

50210	Polished (45016-96)
50218	Chrome



Chrome Trigger Style Levers

Sets include brake and cable clutch handles.

PCP	Year
50220	1982-95
50229	1996-06



Billet Flame Control Set 1996-on

Fits 1996-06 FXD, FXST and 1996-03 XL.
50226

Billet Grips



Billet Chrome Throttle and Grip Set

Swiss cheese design grips can be used with single or dual cable operation.

59259



59583

Spike Billet Grip Set

Will accept single or dual throttle.

59583



Chrome Billet "Twist" Grip Set

Accepts single or dual throttle cable assemblies.

51234



51246



51247

Profile Barrel Grips

Feature chrome accents with barrel shape rubber insert for comfort.

51246 Rail shape

51247 Twist shape



51252



51253

Chrome Barrel Billet Grip Set

For single or dual throttle application.

PCP Style

51252 Flame

51253 Skull



Slugger Billet Grips

Accepts single or dual case operation.

59762

Billet Grips



Chrome Fat Billet Grips

These grips match the O.D. of large bars for symmetry. Both have ID for fit ends and accept single or dual throttle cables.

PCP	Size
59501	1-1/4"
59504	1-1/2"



Chrome Hex Grip Set

Accepts dual or single throttle cable assemblies.

59874



Custom Grip Sets

Chrome "Iso-Rail" and Billet Alloy set require the use of the stock nylon sleeve. Pres-Tech grips have dual cable pulls machined in. (Except models with air resevoirs)

PCP	Type	Finish
51204	Iso-Rail	Chrome with black inserts
51209	P-Tech	Polished with round rubber inserts
51210	P-Tech	As above but chromed



Chrome Flat End Fat Billet Grips

Accepts single or dual throttle cables.

59371



Multi Band Billet Grip Sets

Chrome billet grips feature black band accents.

PCP	Features
51221	Multi-banded giving it the look of chrome slots
51222	Diamond engraving edged with three flat bands on each side



Chrome Billet Maltese Grip Set

Fits single or dual cable applications.

51243

Billet Grips



Chrome Billet Grip Set

Accepts single or dual cables.

PCP	Style
59764	Druid
59763	Batique

Chrome Billet Grip Sets

Single or dual cable assemblies.

PCP	Style
59577	Spiral
59578	Diamond
59595	Smoothie
59761	Milled diamond
59570	Spiral



Chrome Billet Grip Set

Accepts single or dual throttle cable assemblies.

51217	Slotted style
51235	Flame style



Chrome Billet Pirate Grip Set

Accepts single or dual throttle cable assemblies.

PCP	Type
51242	Groove
51249	X-Groove

Billet Gripster Set

Features contoured shape for a firm grip. Accepts single or dual throttle cable assemblies.

59923

Handlebar Grips



ISO Handlebar Grip Set 1982-95
 Chrome grips feature black rubber slots.
51248



Chrome End Grips Sets 1982-95
51241 Skull style



Chrome & Black Rubber Slotted Grips 1996-07
 Fits 1996-07 FXST, Dyna, XL and 1996-07 Touring.
61093 56246-96A (pair)



Hot Rod Flame Grip Set
 Features molded cushion rubber inner sleeve with chrome flame outer sleeve, for looks and comfort.
51244 1982-95
51245 1996-07



Vintage Style Grips
 Grips feature retro molded rubber design with a chrome accent band throttle grip. Includes a nylon sleeve for dual cable operation.

PCP	Application
61069	1996-07 XL, FXST, Dyna and 1996-07 Touring (56275-96B)
51236	Preston, as above
51237	Preston 1982-95 (56276-96A)



Chrome O-Ring Insert Grip Set 1981-95
 Grips include nylon throttle tube for dual or single cable operation.
51238

Handlebar Grips



Contour Grip Set

Grips feature chrome end caps and decorative bands.
61068 1996-07 (56459-01A)



Cushion Throttle and Grip Set

Grips set features cushion grips with chrome insert and chrome end caps. Includes nylon dual throttle-idle tube.
51227 1996-07 (56246-96)
51248 1982-95



Chrome Delta Grip Set

Features a 3 point eccentric form with rubber cushion inserts.
51240



“Eagle Passion” Sets

Feature full cell foam covering for comfort touch.
PCP **Finish/Covering**
51230 Chrome comfort touch foam
51231 Gold inlay comfort touch foam



Chrome Grips with Black Diamond Inserts

51226 1974-07 (set)



Alloy Twist Grips for 1982-95

Knurled with laced leather covers. These grips provide a neat custom look to the standard black rubbers. Medium knurl for a positive grip.
51201 Knurled set with leather

Throttles & Grips



Chrome Diecast Grip Covers

These rubber banded grip covers are beautifully chrome plated and secure with a screw set.

51225 Set



Throttle Assembly Dual Cable

Replaces OEM 56395-81. For 1981-95 Twins with push-pull type cables. Chrome housing with nylon throttle tube.

PCP Fits

- 4782** Dual assembly with grip kit
- 3707** Plastic throttle liner with clamps
- 4783** Grip set
- 2107** Adjuster only
- 50000** Chrome end plug (56238-62) (10 pack)



Throttle Pipe and Grip Sets

Dual cable throttle pipes complete with our replacement grips, and end caps fit all models from 1982-95. Sold in sets.

51251 With rubber grips



T/L Cushion Grips

Black cushion grips with logo chrome end caps. Fits 1982-07 FXST, Dyna, XL and 2000-07 Touring.

63023 Without handlebar filler valve



Throttle Assemblies 1981-95

Dual cable models with chrome throttle clamps offered in either our "Comfort Touch", or Rubber Textured Comfort Touch grips to fit all dual cable models from 1981-95.

With "Comfort Touch" Grips

51213 Dual cable

With Rubber Textured Grips

51219 Dual cable

Grips & Accessories



Inner Throttle Sleeve

Custom design allows pull action of throttle cable when using billet grips.

59730

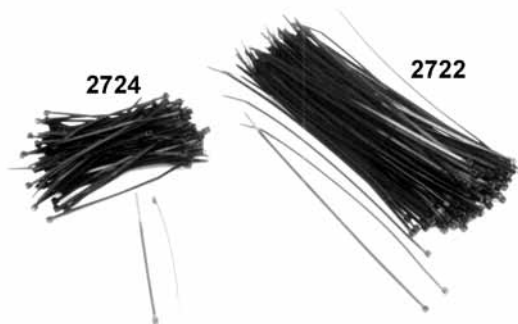

Black Cable Ties

Sold in bag of 100.

2724 4"

2722 7"



Chrome Throttle Clamps

Features smooth design and includes upper and lower pieces with screws for dual cable applications 1982-95.

73507

Throttle Control Adjusting Screw

Throttle return adjusting screw for all models 1974-on with stock throttle or our #4780 or #4782 chrome throttle controls. Includes spring.

2107 56397-74A & 56394-74



2107

Dual Billet Throttle Housing

For use with screw-in idle and throttle cable.

73713

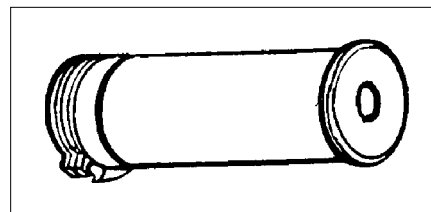

Throttle Grip & Liner Tube Assembly

PCP Fits
3709 H-D 1981-07 (56220-81)



51013

Nylon Throttle Tubes

PCP Type
51012 Single 1973-80
51013 Dual 1981-07



4785

Dual Throttle Clamp Sets

Chrome die-cast clamp sets include the upper and lower clamp with screws.

4785



5440



23092

1952 Waffle Style Stock Grips

Replica-waffle style for 1974-on with 1" & 1-1/8". Sold in pairs.

5440 Black

23092 White

Grips & Accessories



Brake Line & Throttle Cable Clamps

For detailing with routing cables, brake lines, & other linkages, our custom clamps are the perfect choice. Our fully machined aluminum clamps are beautifully chrome plated. The big ends fit all the common fork tubes, glide, narrow glide, & 39mm.

- 27510** 1"
- 27511** 1-1/8"
- 27512** 1-1/4"
- 27513** 35mm 1-3/8"
- 27515** 39mm

Chrome Cable Clamps

Chrome cable clamps are a trick way of holding those hanging throttle cables in place. Machined from alloy and chrome plated. Clamps onto 1" bars. (imported)

- 27525** Single cable
- 27526** Dual cables



60" Chrome Cable Wrap

Is a classic 1950's style chrome dresser trim item, I.D. size noted (5mm is about 3/16") Sold in 5 foot rolls

- 45196** 5mm
- 45197** 7mm
- 45198** 9mm



Vintage Style Grip Set

These grips are styled after the logo type 1909 early grips, but are designed to fit late model bars and throttles. 1974-on and all universal 1" and 1-1/8" twist assemblies.

- 23091** Black
- 5430** White

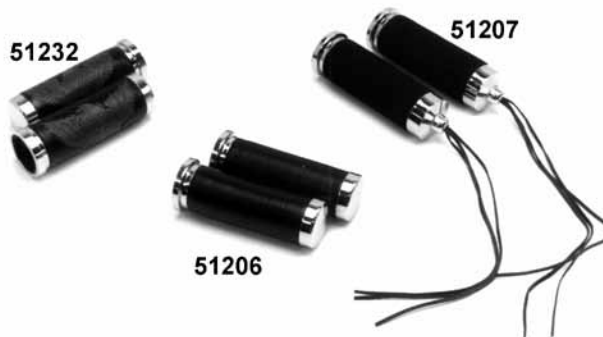

Chrome End Grip Sets

Feature comfort touch grip area either with foam or leather covering to reduce vibration. Chrome plated end cap with either smooth cap or fringes.

- 51232** Smooth cap w/black tooled eagle
- 51233** Smooth cap w/brown tooled eagle
- 51206** Smooth cap, leather black
- 51207** With fringe

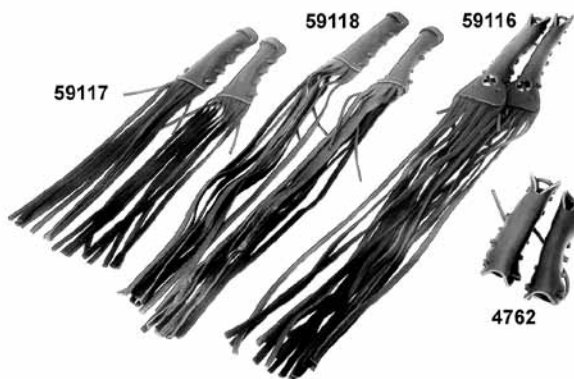

Leather Handlebar Accessories

Genuine black leather grip and lever covers. These custom crafted accessories are complete with laces giving you the look, feel and comfort of leather. We recommend using an adhesive when installing to ensure a secure fit. Sold in pairs.

- 4762** Lever cover to 1992
- 59115** As above with 10" fringe
- 59116** As above 16" fringe
- 59117** Lever covers 1993-on
- 51220** As above with 10" fringe
- 59118** As above with 16" fringe



Stock Grip Sets 1974-on

Replaces 56206-74 for 1974-on FX, FL models with 1-1/8" and 1" size.

- | Black | Application |
|--------------|--|
| 23093 | 1974-on with chrome plugs |
| 23095 | 1974-on, no plugs |
| 23096 | 1981-on, does not accept chrome plugs |
| 23087 | 1981-on left side, does not accept chrome plugs (ea) |